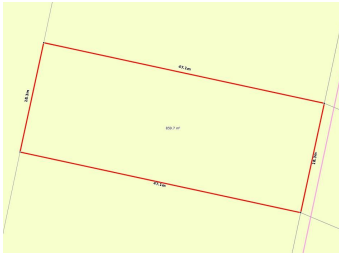

STATEMENT OF INFORMATION

Section 47AF of the Estate Agents Act 1980

**135 WOORALLA DRIVE, MOUNT ELIZA,**

3
 2
 2

Indicative Selling Price

For the meaning of this price see consumer.vic.au/underquotingPrice Range: **\$1,850,000 to \$2,000,000**

Provided by: Natasha Lamb , Ray White Frankston

MEDIAN SALE PRICE

**MOUNT ELIZA, VIC, 3930**

Suburb Median Sale Price (House)

\$1,552,500

01 October 2024 to 31 March 2025

Provided by: pricefinder

COMPARABLE PROPERTIES

These are the three properties sold within two kilometres of the property for sale in the last six months that the estate agent or agents representative considers to be most comparable to the property for sale.

**37 BARMAN ST, MOUNT ELIZA, VIC 3930**

4
 3
 2

Sale Price

***\$1,920,000**

Sale Date: 28/01/2025

Distance from Property: 2km

**29 BARMAN ST, MOUNT ELIZA, VIC 3930**

5
 2
 2

Sale Price

***\$1,900,000**

Sale Date: 13/05/2025

Distance from Property: 2.1km

**22-24 CLAREMONT ST, MOUNT ELIZA, VIC**

4
 2
 2

Sale Price

\$1,860,000

Sale Date: 07/12/2024

Distance from Property: 906m



This report has been compiled on 14/05/2025 by Ray White Frankston. Property Data Solutions Pty Ltd 2025 - www.pricefinder.com.au

© The State of Victoria owns the copyright in the property sales data and reproduction of that data in any way without the consent of the State of Victoria will constitute a breach of the Copyright Act 1968 (Cth). The State of Victoria does not warrant the accuracy or completeness of the licensed material and any person using or relying upon such information does so on the basis that the State of Victoria accepts no responsibility or liability whatsoever for any errors, faults, defects or omissions in the information supplied.

Statement of Information

Single residential property located in the Melbourne metropolitan area

Sections 47AF of the Estate Agents Act 1980

Instructions: The instructions in this box do not form part of this Statement of Information and are not required to be included in the completed Statement of Information for the property being offered for sale.

The Director of Consumer Affairs Victoria has approved this form of the Statement of Information for section 47AF of the *Estate Agents Act 1980*.

The estate agent or agent's representative engaged to sell the property is required to prepare this Statement of Information. It must be used when **a single residential property located in the Melbourne metropolitan area** is being offered for sale. The Determination setting out the local government areas that comprise the Melbourne metropolitan area is published on the Consumer Affairs Victoria website at **consumer.vic.gov.au/underquoting**. The indicative selling price in this Statement of Information may be expressed as a single price, or as a price range with the difference between the upper and lower amounts not more than 10% of the lower amount.

This Statement of Information must be provided to a prospective buyer within two business days of a request and displayed at any open for inspection for the property for sale.

It is recommended that the address of the property being offered for sale be checked at services.land.vic.gov.au/landchannel/content/addressSearch before being entered in this Statement of Information.

Property offered for sale

Address
Including suburb and
postcode

135 WOORALLA DRIVE, MOUNT ELIZA, VIC 3930

Indicative selling price

For the meaning of this price see consumer.vic.gov.au/underquoting

Price Range:

\$1,850,000 to \$2,000,000

Median sale price

Median price

\$1,552,500

Property type

House

Suburb

MOUNT ELIZA

Period

01 October 2024 to 31 March 2025

Source



Comparable property sales

These are the three properties sold within two kilometres of the property for sale in the last six months that the estate agent or agents representative considers to be most comparable to the property for sale.

Address of comparable property	Price	Date of sale
37 BARMAH ST, MOUNT ELIZA, VIC 3930	*\$1,920,000	28/01/2025
29 BARMAH ST, MOUNT ELIZA, VIC 3930	*\$1,900,000	13/05/2025
22-24 CLAREMONT ST, MOUNT ELIZA, VIC 3930	\$1,860,000	07/12/2024

This Statement of Information was prepared on:

14/05/2025