

Statement of Information

Single residential property located in the Melbourne metropolitan area

Section 47AF of the Estate Agents Act 1980

Property offered for sale

Address
Including suburb and
postcode

12 Bamfield Close, Templestowe Vic 3106

Indicative selling price

For the meaning of this price see consumer.vic.gov.au/underquoting

Single price

\$2,400,000

Median sale price

Median price

\$1,730,500

Property Type

House

Suburb

Templestowe

Period - From

01/04/2024

to

31/03/2025

Source

REIV

Comparable property sales (*Delete A or B below as applicable)

A* These are the three properties sold within two kilometres of the property for sale in the last six months that the estate agent or agent's representative considers to be most comparable to the property for sale.

	Address of comparable property	Price	Date of sale
1	9 Berwyn Cr TEMPLESTOWE 3106	\$2,650,000	10/05/2025
2	1 Willowbank Ct TEMPLESTOWE 3106	\$2,640,000	21/04/2025
3	9 Bamfield CI TEMPLESTOWE 3106	\$2,610,000	22/02/2025

OR

~~**B*** The estate agent or agent's representative reasonably believes that fewer than three comparable properties were sold within two kilometres of the property for sale in the last six months.~~

This Statement of Information was prepared on:

17/06/2025 08:35

12 Bamfield Close, Templestowe Vic 3106



first
national
REAL ESTATE | Bill Schlink

Isaac Fakhri

03 9846 2111

0499 425 715

isaac@billschlink.com.au

Indicative Selling Price

\$2,400,000

Median House Price

Year ending March 2025: \$1,730,500

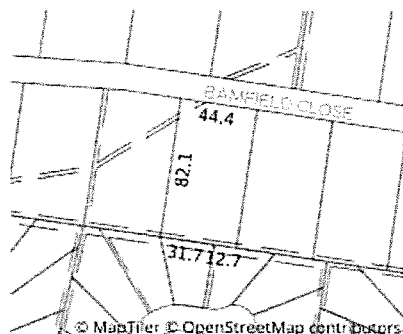

Rooms: 2

Property Type: House

Land Size: 3651.111 sqm approx

Agent Comments

Comparable Properties

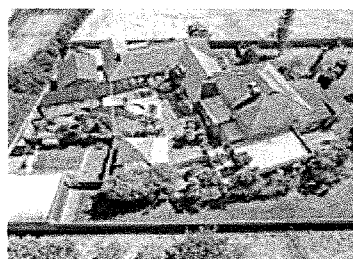

9 Berwyn Cr TEMPLESTOWE 3106 (REI)

Agent Comments



Price: \$2,650,000

Method: Auction Sale

Date: 10/05/2025

Property Type: House (Res)

Land Size: 4096 sqm approx



1 Willowbank Ct TEMPLESTOWE 3106 (REI)

Agent Comments



Price: \$2,640,000

Method: Private Sale

Date: 21/04/2025

Property Type: House

Land Size: 2978 sqm approx

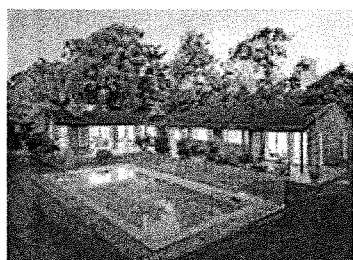

9 Bamfield Ct TEMPLESTOWE 3106 (REI)

Agent Comments



Price: \$2,610,000

Method: Auction Sale

Date: 22/02/2025

Property Type: House (Res)

Land Size: 3684 sqm approx

Account - Bill Schlink First National | P: 03 9846 2111 | F: 03 9846 5241



The State of Victoria owns the copyright in the property sales data and reproduction of that data in any way without the consent of the State of Victoria will constitute a breach of the Copyright Act 1968 (Cth). The State of Victoria does not warrant the accuracy or completeness of the licensed material and any person using or relying upon such information does so on the basis that the State of Victoria accepts no responsibility or liability whatsoever for any errors, faults, defects or omissions in the information supplied. This information is supplied by Property Data Pty Ltd on behalf of the Real Estate Institute of Victoria.

The information contained herein is to be used as a guide only. Although every care has been taken in the preparation of the information, we stress that particulars herein are for information only and do not constitute representations by the Owners or Agent. Sales data is provided as a guide to market activity, and we do not necessarily claim to have acted as the selling agent in these transactions.