

Statement of Information

Single residential property located outside the Melbourne metropolitan area

Section 47AF of the Estate Agents Act 1980

Property offered for sale

Address
Including suburb and
postcode

12 AINSLEY COURT ECHUCA VIC 3564

Indicative selling price

For the meaning of this price see consumer.vic.gov.au/underquoting (*Delete single price or range as applicable)

Single Price

\$985,000

or range
between

&

Median sale price

(*Delete house or unit as applicable)

Median Price

\$550,000

Property type

House

Suburb

Echuca

Period-from

01 Mar 2024

to

28 Feb 2025

Source

Corelogic

Comparable property sales (*Delete A or B below as applicable)

A* These are the three properties sold within five kilometres of the property for sale in the last 18 months that the estate agent or agent's representative considers to be most comparable to the property for sale.

Address of comparable property

Price

Date of sale

12 SCOTT ROAD ECHUCA VIC 3564	\$1,028,000	09-Apr-24
3 LAWLER COURT ECHUCA VIC 3564	\$1,192,770	19-Dec-23
8 AINSLEY COURT ECHUCA VIC 3564	\$1,260,000	11-Jan-24

OR

B* ~~The estate agent or agent's representative reasonably believes that fewer than three comparable properties were sold within five kilometres of the property for sale in the last 18 months.~~

This Statement of Information was prepared on: 25 March 2025



12 SCOTT ROAD ECHUCA VIC 3564 Sold Price **\$1,028,000** Sold Date **09-Apr-24**

4 2 4

Distance **2.61km**



3 LAWLER COURT ECHUCA VIC 3564 Sold Price **\$1,192,770** Sold Date **19-Dec-23**

3 2 3

Distance **0.7km**

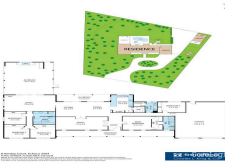

8 AINSLEY COURT ECHUCA VIC 3564 Sold Price **\$1,260,000** Sold Date **11-Jan-24**

5 2 6

Distance **0.1km**

RS = Recent sale UN = Undisclosed Sale

DISCLAIMER Whilst all reasonable effort is made to ensure the information in this publication is current, CoreLogic does not warrant the accuracy or completeness of the data and information contained in this publication and to the full extent not prohibited by law excludes all liability for any loss or damage arising in connection with the data and information contained in this publication.

The State of Victoria owns the copyright in the Property Sales Data and reproduction of that data in any way without the consent of the State of Victoria will constitute a breach of the Copyright Act 1968 (Cth). The State of Victoria does not warrant the accuracy or completeness of the Property Sales Data and any person using or relying upon such information does so on the basis that the State of Victoria accepts no responsibility or liability whatsoever for any errors, faults, defects or omissions in the information supplied.