

Statement of Information

Single residential property located outside the Melbourne metropolitan area

Section 47AF of the Estate Agents Act 1980

Property offered for sale

Address
Including suburb or
locality and postcode

1/39 Palmerston St, Sale Vic 3850

Indicative selling price

For the meaning of this price see consumer.vic.gov.au/underquoting

Single price \$272,000

Median sale price

Median price \$260,000

Property Type Vacant land

Suburb Sale

Period - From 03/10/2023

to 02/10/2024

Source REIV

Comparable property sales (*Delete A or B below as applicable)

~~A* These are the three properties sold within five kilometres of the property for sale in the last eighteen months that the estate agent or agent's representative considers to be most comparable to the property for sale.~~

Address of comparable property	Price	Date of sale
1		
2		
3		

OR

B* The estate agent or agent's representative reasonably believes that fewer than three comparable properties were sold within five kilometres of the property for sale in the last eighteen months.

This Statement of Information was prepared on:

03/10/2024 09:12

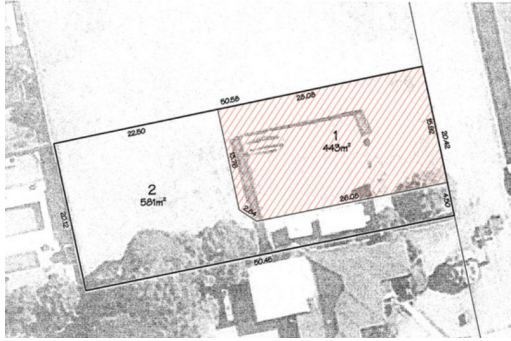

Property Type:
Agent Comments

Indicative Selling Price
\$272,000

Median Land Price
03/10/2023 - 02/10/2024: \$260,000

Comparable Properties

The estate agent or agent's representative reasonably believes that fewer than three comparable properties were sold within five kilometres of the property for sale in the last eighteen months.

Account - Gippsland Real Estate Maffra | P: 03 5147 2200 | F: 03 5147 2800