

Statement of Information

Single residential property located outside the Melbourne metropolitan area

Section 47AF of the Estate Agents Act 1980

Property offered for sale

Address
Including suburb or
locality and postcode

123 Minto Road, Flowerdale Vic 3717

Indicative selling price

For the meaning of this price see consumer.vic.gov.au/underquoting

Range between \$550,000 & \$600,000

Median sale price

Median price \$210,000 Property Type Vacant land Suburb Flowerdale

Period - From 29/09/2020 to 28/09/2021 Source REIV

Comparable property sales (*Delete A or B below as applicable)

~~A* These are the three properties sold within five kilometres of the property for sale in the last eighteen months that the estate agent or agent's representative considers to be most comparable to the property for sale.~~

Address of comparable property	Price	Date of sale
1		
2		
3		

OR

~~B* The estate agent or agent's representative reasonably believes that fewer than three comparable properties were sold within five kilometres of the property for sale in the last eighteen months.~~

This Statement of Information was prepared on: 29/09/2021 14:09

123 Minto Road, Flowerdale Vic 3717

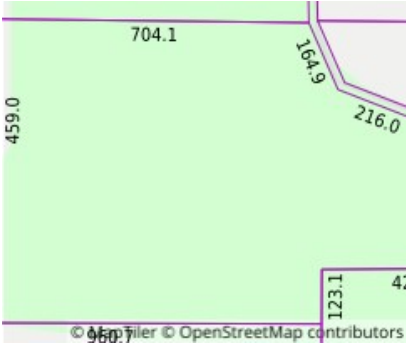

Property Type:
Divorce/Estate/Family Transfers
Land Size: 674100 sqm approx
Agent Comments

Jordyn Kruger
5786 2033
0412 747 032
jordyn@integrityrealestate.net.au

Indicative Selling Price
\$550,000 - \$600,000
Median Land Price
29/09/2020 - 28/09/2021: \$210,000

Comparable Properties

The estate agent or agent's representative reasonably believes that fewer than three comparable properties were sold within five kilometres of the property for sale in the last eighteen months.

Account - Integrity Real Estate | P: 03 9730 2333 | F: 03 9730 2888



The State of Victoria owns the copyright in the property sales data and reproduction of that data in any way without the consent of the State of Victoria will constitute a breach of the Copyright Act 1968 (Cth). The State of Victoria does not warrant the accuracy or completeness of the licensed material and any person using or relying upon such information does so on the basis that the State of Victoria accepts no responsibility or liability whatsoever for any errors, faults, defects or omissions in the information supplied.

The information contained herein is to be used as a guide only. Although every care has been taken in the preparation of the information, we stress that particulars herein are for information only and do not constitute representations by the Owners or Agent. Sales data is provided as a guide to market activity, and we do not necessarily claim to have acted as the selling agent in these transactions.