

SARDELIC REAL ESTATE

For Sale

\$1,375,000

 3  2  2

5/13 TWEEDDALE RD
APPLECROSS

Simmon Sardelic
0414 924 950

simmon@sardelic.com.au

155 Canning Hwy
South Perth
9474 3222

SARDELIC
REAL ESTATE

PROPERTY DETAILS

BEAUTIFULLY PRESENTED APARTMENT IN QUIET GROUP OF 7

What a super location -The Golden Triangle! 13 Tweeddale Road is an apartment complex that comprises of seven luxury apartments. Located approximately 9km from the Perth CBD, 500m stroll to the iconic Raffles Hotel.

Built in 2008 it offers a high level of finish and offers a fantastic level security in an extremely prestigious suburb. The building offers a Gym and alfresco entertaining areas and is superbly located approximately 250 m from the Swan River and 500m to the Iconic Raffles Hotel. Access to the Perth CBD is only 6 kms away.

This private apartment offers a North facing aspect offering a light and bright aspect.

Here are just some of the features:

- * 3 large bedrooms & 2 bathrooms, both bathrooms with full height tiling, stone bench tops
 - * Master bedroom has an Ensuite bathroom with spa bath and double vanities
 - * Spacious Family/Dining with a gourmet style kitchen
 - * Kitchen finish is exemplary with a stone benchtop, glass splashback, return pantry plus..
 - * Gas Cooktop and Miele Dishwasher
 - * Built in cabinetry makes storage a breeze.
 - * Activity room can be utilised as a home office or kids activity room
 - * Well appointed laundry with built in cabinetry
 - * Balcony offers relaxing sunsets and views heightened by the cedar ceiling.
 - * Winter or Summer? Stay cool or warm with ducted reverse cycle
- * Water Rates: \$1,800 per annum -no usage charged * Council Rates:\$ 2,800 per annum
- * Strata Levies: \$2,100 per quarter

For a private viewing please contact the exclusive selling agent Simmon Sardelic on

(0414) 924 950

5/13 Tweeddale Road Applecross

SARDELIC
REAL ESTATE

FLOOR PLAN

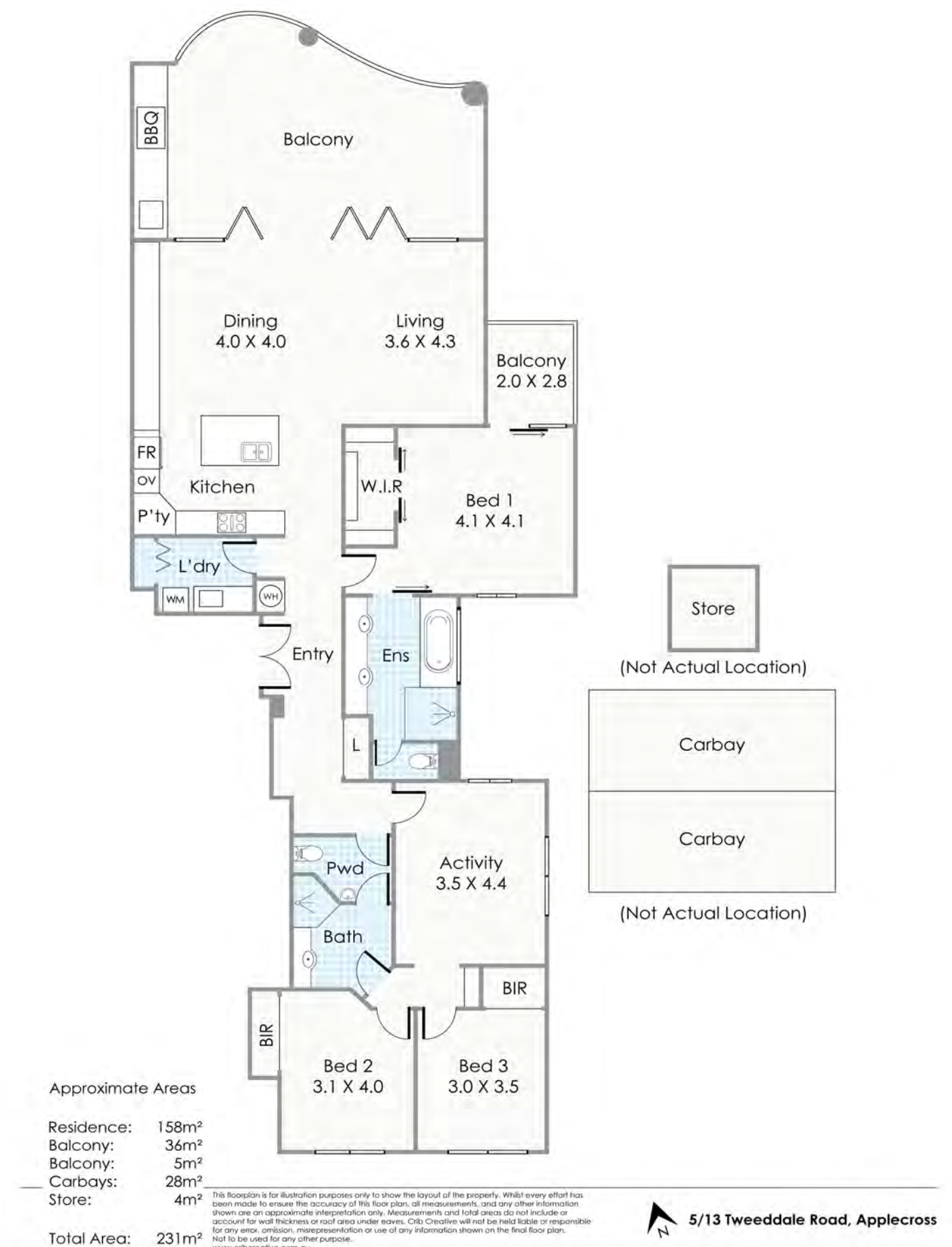

5/13 Tweeddale Road Applecross

SARDELIC
REAL ESTATE

PHOTOGRAPHS



5/13 Tweeddale Road Applecross

SARDELIC
REAL ESTATE

PHOTOGRAPHS

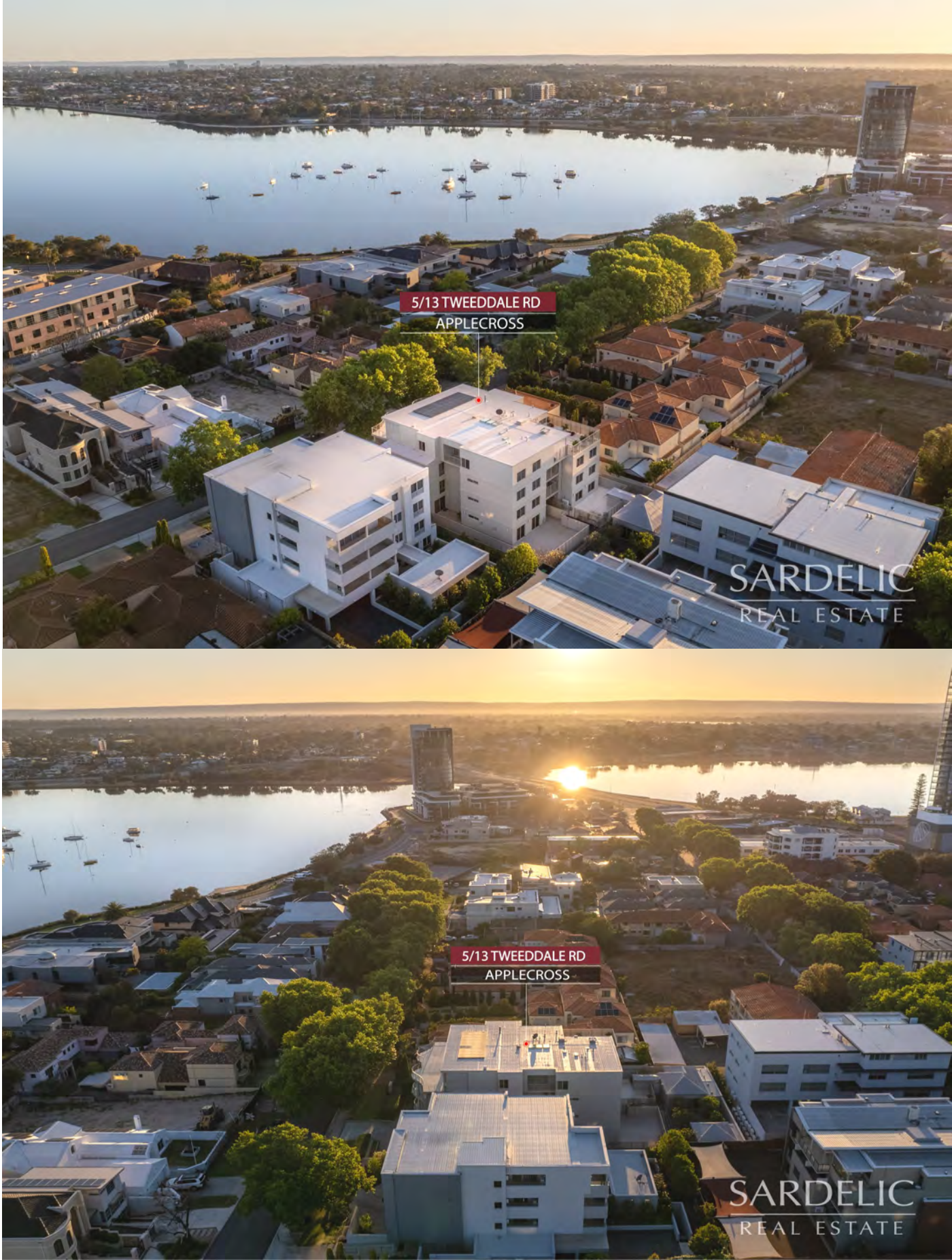

5/13 Tweeddale Road Applecross

SARDELIC
REAL ESTATE

PHOTOGRAPHS



5/13 Tweeddale Road Applecross

SARDELIC
REAL ESTATE

PHOTOGRAPHS



5/13 Tweeddale Road Applecross

SARDELIC
REAL ESTATE

PHOTOGRAPHS



5/13 Tweeddale Road Applecross

PHOTOGRAPHS



5/13 Tweeddale Road Applecross

Master Bedroom



5/13 Tweeddale Road Applecross

Master Bedroom



5/13 Tweeddale Road Applecross

Master Ensuite



5/13 Tweeddale Road Applecross

PHOTOGRAPHS



5/13 Tweeddale Road Applecross

SARDELIC
REAL ESTATE

PHOTOGRAPHS



5/13 Tweeddale Road Applecross

SARDELIC
REAL ESTATE

Common Entertainment Area



5/13 Tweeddale Road Applecross

RECENT SALES

4/70 Gairloch Street Applecross WA

<https://www.realestate.com.au/sold/property-house-wa-applecross-136685330>

Sale Price: \$1,040,000 Sale Date: Aug 21 Details: 200 sqm 3 bed 2 bath

2205/908 Canning Highway Applecross WA

<https://reiwa.com.au/2205-908-canning-highway-4499328/>

Sale Price: \$1.330,000 Sale Date: July 21 Details: 212 sqm 3 bed 2 bath

3/13 Tweeddale Road Applecross WA

<https://www.realestate.com.au/property/unit-3-13-tweeddale-rd-applecross-wa-6153>

Sale Price: \$1,430,000 Sale Date: June 21 Details: 231 sqm 3 bed 2 bath

203/36 Kintail Road Applecross WA

<https://www.realestate.com.au/sold/property-apartment-wa-applecross-135877186>

Sale Price: \$1,450,000 Sale Date: May 21 Details: 218 sqm 3 bed bath

2304/908 Canning Highway Applecross WA

<https://www.realestate.com.au/sold/property-apartment-wa-applecross-134478074>

Sale Price: \$1,325,000 Sale Date: March 21 Details: 213 sqm 3 bed 2 bath

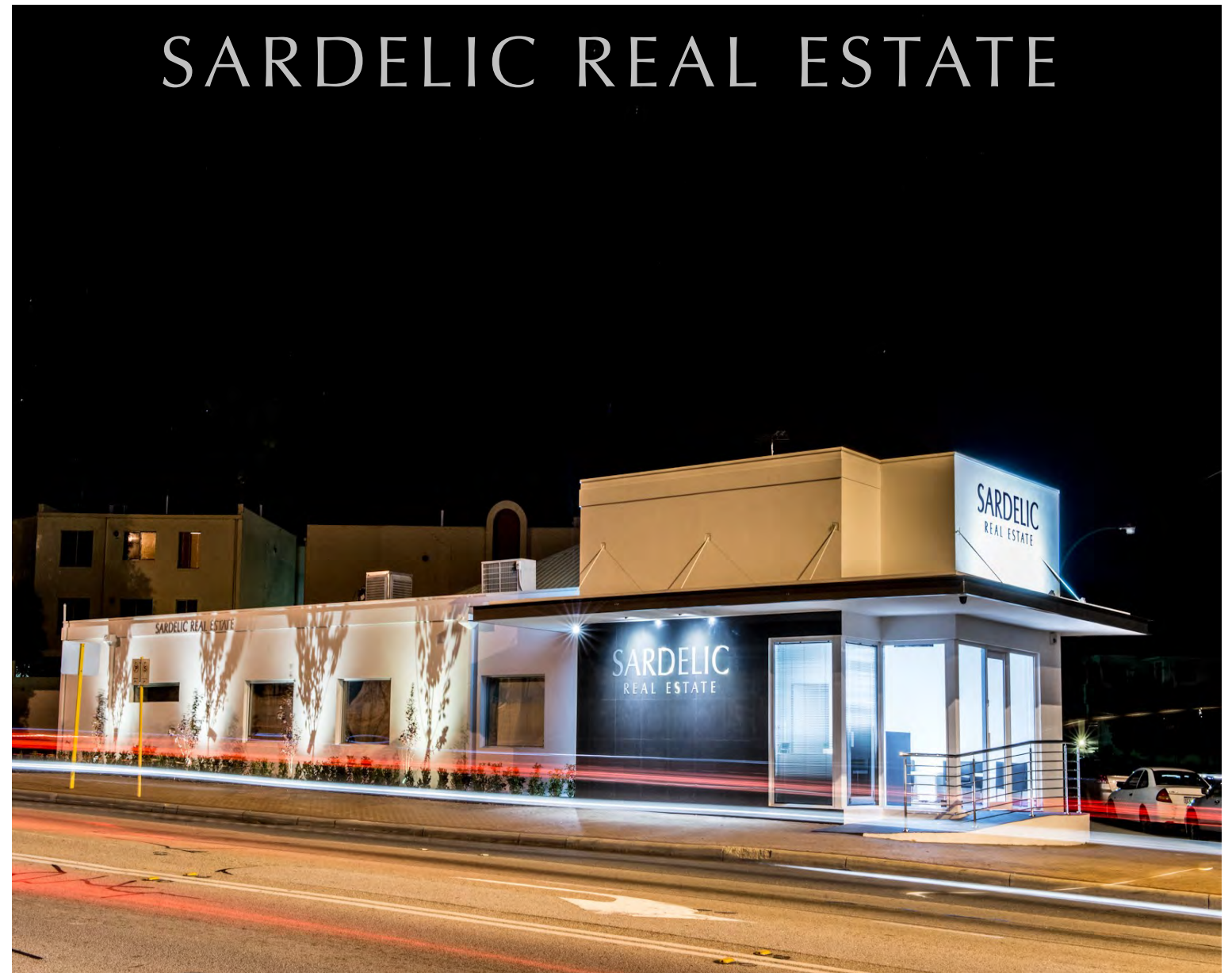

For a comprehensive report on the value of your property please email - simmon@sardelic.com.au

Sardelic Real Estate has been a significant part of the local real estate community since 1989. Prominently located on Canning Highway via Elizabeth St in South Perth, the business has evolved to become a stable, highly respected Agency specializing in the following areas:

- Residential Property Management
- Commercial Property Management
- Residential Sales
- Commercial Sales & Leasing
- Residential Development Consultancy
- Specialist Consulting and Valuation

www.sardelic.com.au

(9)474 3222

SARDELIC
REAL ESTATE