

Statement of Information

Single residential property located in the Melbourne metropolitan area

Section 47AF of the Estate Agents Act 1980

Property offered for sale

Address
Including suburb and
postcode

43 Killarney Ridge, Greensborough Vic 3088

Indicative selling price

For the meaning of this price see consumer.vic.gov.au/underquoting

Range between

\$900,000

&

\$990,000

Median sale price

Median price

\$772,500

Property Type

House

Suburb

Greensborough

Period - From

01/07/2018

to

30/06/2019

Source

REIV

Comparable property sales (*Delete A or B below as applicable)

~~A* These are the three properties sold within two kilometres of the property for sale in the last six months that the estate agent or agent's representative considers to be most comparable to the property for sale.~~

Address of comparable property	Price	Date of sale
1		
2		
3		

OR

~~B* The estate agent or agent's representative reasonably believes that fewer than three comparable properties were sold within two kilometres of the property for sale in the last six months.~~

This Statement of Information was prepared on:

30/09/2019 11:33

Daniel Leibowitz

03 9432 2544

0428 812 636

daniel@darrenjones.com.au

Indicative Selling Price

\$900,000 - \$990,000

Median House Price

Year ending June 2019: \$772,500

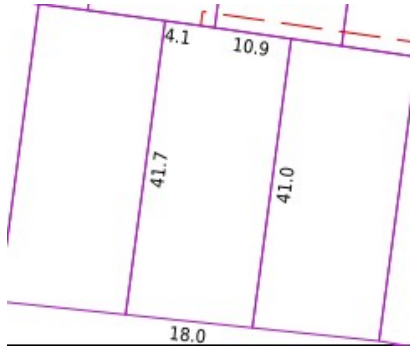

Property Type: Land

Land Size: 745 sqm approx

Agent Comments

Comparable Properties

The estate agent or agent's representative reasonably believes that fewer than three comparable properties were sold within two kilometres of the property for sale in the last six months.