

Statement of Information

Single residential property located outside the Melbourne metropolitan area

Section 47AF of the Estate Agents Act 1980

Property offered for sale

Address
Including suburb or
locality and postcode

729 La Trobe Street, Redan Vic 3350

Indicative selling price

For the meaning of this price see consumer.vic.gov.au/underquoting

Single price

\$349,000

Median sale price

Median price

\$305,000

House

X

Unit

Suburb or locality

Redan

Period - From

01/07/2017

to

30/06/2018

Source

REIV

Comparable property sales (*Delete A or B below as applicable)

~~A* These are the three properties sold within five kilometres of the property for sale in the last eighteen months that the estate agent or agent's representative considers to be most comparable to the property for sale.~~

Address of comparable property	Price	Date of sale
1		
2		
3		

OR

B* The estate agent or agent's representative reasonably believes that fewer than three comparable properties were sold within five kilometres of the property for sale in the last eighteen months.

729 La Trobe Street, Redan Vic 3350

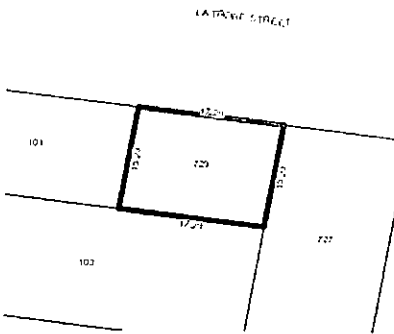

Rooms:
Property Type:
Agent Comments

Indicative Selling Price
\$339,000
Median House Price
Year ending June 2018: \$305,000

Comparable Properties

The estate agent or agent's representative reasonably believes that fewer than three comparable properties were sold within five kilometres of the property for sale in the last eighteen months.