

Statement of Information

Single residential property located in the Melbourne metropolitan area

Section 47AF of the Estate Agents Act 1980

Property offered for sale

Address Including suburb and postcode 4/25 Mount Pleasant Road, Nunawading Vic 3131

Indicative selling price

For the meaning of this price see consumer.vic.gov.au/underquoting

Range between \$565,000 & \$620,000

Median sale price

Median price \$713,500 House Unit X Suburb Nunawading

Period - From 01/10/2017 to 31/12/2017 Source REIV

Comparable property sales (*Delete A or B below as applicable)

A* These are the three properties sold within two kilometres of the property for sale in the last six months that the estate agent or agent's representative considers to be most comparable to the property for sale.

	Address of comparable property	Price	Date of sale
1	3/31 Mount Pleasant Rd NUNAWADING 3131	\$620,500	03/03/2018
2	1/30 Mount Pleasant Rd NUNAWADING 3131	\$611,000	16/01/2018
3	13/39 Mount Pleasant Rd NUNAWADING 3131	\$568,500	14/11/2017

OR

B* The estate agent or agent's representative reasonably believes that fewer than three comparable properties were sold within two kilometres of the property for sale in the last six months.

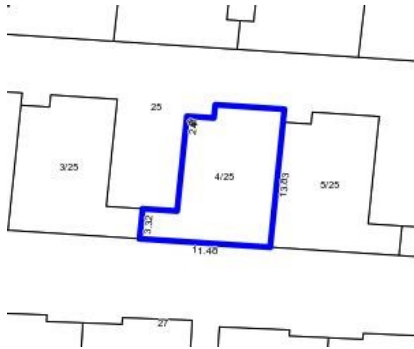

 2  1  1

Rooms:
Property Type: House
Agent Comments

Indicative Selling Price
\$565,000 - \$620,000
Median Unit Price
December quarter 2017: \$713,500

Comparable Properties



3/31 Mount Pleasant Rd NUNAWADING 3131 (REI) **Agent Comments**

 2  1  1

Price: \$620,500
Method: Auction Sale
Date: 03/03/2018
Rooms: -
Property Type: Unit

1/30 Mount Pleasant Rd NUNAWADING 3131 (VG) **Agent Comments**

 2  -  -

Price: \$611,000
Method: Sale
Date: 16/01/2018
Rooms: -
Property Type: Flat/Unit/Apartment (Res)



13/39 Mount Pleasant Rd NUNAWADING 3131 (REI/VG) **Agent Comments**

 2  1  1

Price: \$568,500
Method: Auction Sale
Date: 14/11/2017
Rooms: 3
Property Type: Unit