

Statement of Information

Single residential property located in the Melbourne metropolitan area

Section 47AF of the Estate Agents Act 1980

Property offered for sale

Address Including suburb and postcode 2/10 Ware Crescent, Ringwood East Vic 3135

Indicative selling price

For the meaning of this price see consumer.vic.gov.au/underquoting

Range between \$550,000 & \$595,000

Median sale price

Median price \$612,500 House Unit X Suburb Ringwood East

Period - From 01/07/2018 to 30/09/2018 Source REIV

Comparable property sales (*Delete A or B below as applicable)

~~A* These are the three properties sold within two kilometres of the property for sale in the last six months that the estate agent or agent's representative considers to be most comparable to the property for sale.~~

Address of comparable property	Price	Date of sale
1		
2		
3		

OR

B* The estate agent or agent's representative reasonably believes that fewer than three comparable properties were sold within two kilometres of the property for sale in the last six months.

2/10 Ware Crescent, Ringwood East Vic 3135

Noel Jones

Matthew Scafidi

9837 4444

0433 795 006

matthew.scafidi@noeljones.com.au

Indicative Selling Price

\$550,000 - \$595,000

Median Unit Price

September quarter 2018: \$612,500

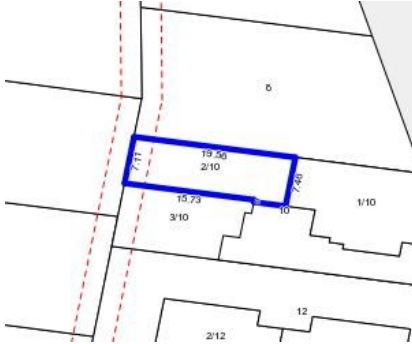

Rooms:

Property Type:

Agent Comments

Comparable Properties

The estate agent or agent's representative reasonably believes that fewer than three comparable properties were sold within two kilometres of the property for sale in the last six months.