

Statement of Information

Single residential property located in the Melbourne metropolitan area

Section 47AF of the Estate Agents Act 1980

Property offered for sale

Address
Including suburb and
postcode

24 Mayfair Avenue, Templestowe Lower Vic 3107

Indicative selling price

For the meaning of this price see consumer.vic.gov.au/underquoting

Range between \$1,300,000 & \$1,430,000

Median sale price

Median price \$768,000 Unit X Suburb Templestowe Lower

Period - From 01/01/2017 to 31/03/2017 Source REIV

Comparable property sales

The estate agent or agent's representative reasonably believes that fewer than three comparable properties were sold within two kilometres of the property for sale in the last six months.

24 Mayfair Avenue, Templestowe Lower Vic 3107



George Pangalos

03 9842 8888

0430 060 123

gpangalos@barryplant.com.au

Indicative Selling Price

\$1,300,000 - \$1,430,000

Median Unit Price

March quarter 2017: \$768,000

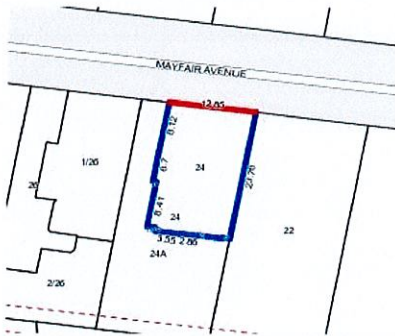

4 2 2

Rooms:

Property Type: Townhouse

Land Size: 301.50 sqm approx

Agent Comments

Comparable Properties

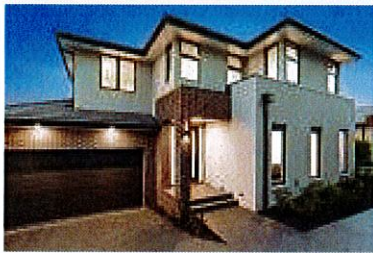

2/5 Rooney St TEMPLESTOWE LOWER 3107 (REI)

Agent Comments

4 2 2

Price: \$1,306,000

Method: Auction Sale

Date: 24/06/2017

Rooms: 7

Property Type: Townhouse (Res)

The estate agent or agent's representative reasonably believes that fewer than three comparable properties were sold within two kilometres of the property for sale in the last six months.