

SECTION 32 STATEMENT

PURSUANT TO DIVISION 2 OF PART II
SECTION 32 OF THE SALE OF LAND ACT 1962 (VIC)

Vendor:	Andrew William Moffat
Property:	8 Moscript Street CAMPBELLS CREEK VIC 3451 being the land more particularly described in Certificate of Title Volume 8097 Folio 527



GRIFFIN CONVEYANCING

Griffin Conveyancing
PO Box 693 CASTLEMAINE VIC 3450

Tel: 03 5472 5452

Fax: 03 5472 5459

Email: conveyancing@griffinconveyancing.com.au

Ref: vmofmos

SECTION 32 STATEMENT
8 MOSCRIPT STREET CAMPBELLS CREEK VIC 3451

32A FINANCIAL MATTERS

Information concerning any rates, taxes, charges or other similar outgoings AND any interest payable on any part of them is contained in the attached certificate/s and as follows-

Provider	Amount (& interest if any)	Period
Coliban Water		
Mount Alexander Shire Council		

Any further amounts (including any proposed Owners Corporation Levy) for which the Purchaser may become liable as a consequence of the purchase of the property are as follows:-

None to the vendors knowledge

Their total does not exceed \$3,500.00

At settlement the rates will be adjusted between the parties, so that they each bear the proportion of rates applicable to their respective periods of occupancy in the property.

32A(b)The particulars of any Charge (whether registered or not) over the land imposed by or under an Act to secure an amount due under that Act, including the amount owing under the charge are as follows:-
Not Applicable

32B INSURANCE

- (a) Where the Contract does not provide for the land to remain at the risk of the Vendor, particulars of any policy of insurance maintained by the Vendor in respect of damage to or destruction of the land are as follows: - Not Applicable
- (b) Where there is a residence on the land which was constructed within the preceding six years, and section 137B of the *Building Act 1993* applies, particulars of the required insurance are as follows:-
Not Applicable

32C LAND USE

(a) **RESTRICTIONS**

Information concerning any easement, covenant or similar restriction affecting the land (whether registered or unregistered) is as follows:-

- Easements affecting the land are as set out in the attached copies of title.
- Covenants affecting the land are as set out in the attached copies of title.
- Other restrictions affecting the land are as attached.
- Particulars of any existing failure to comply with the terms of such easement, covenant and/or restriction are as follows:-

To the best of the Vendor's knowledge there is no existing failure to comply with the terms of any easement, covenant or similar restriction affecting the land. The Purchaser should note that there may be sewers, drains, water pipes, underground and/or overhead electricity cables, underground and/or overhead telephone cables and underground gas pipes laid outside any registered easements and which are not registered or required to be registered against the Certificate of Title.

SECTION 32 STATEMENT
8 MOSCRIPT STREET CAMPBELLS CREEK VIC 3451

(b) BUSHFIRE

This land is in a designated bushfire- prone area within the meaning of the regulations made under the *Building Act 1993*.

(c) ROAD ACCESS

There is access to the Property by Road.

(d) PLANNING

Planning Scheme: See attached certificate

Responsible Authority: Mount Alexander Shire Council

Zoning: See attached certificate

Planning Overlay/s: See attached certificate

32D NOTICES

- (a) Particulars of any Notice, Order, Declaration, Report or recommendation of a Public Authority or Government Department or approved proposal directly and currently affecting the land of which the Vendor might reasonably be expected to have knowledge are:-
None to the Vendors knowledge however the Vendor has no means of knowing all decisions of the Government and other authorities unless such decisions have been communicated to the Vendor
- (b) The Vendor is not aware of any Notices, Property Management Plans, Reports or Orders in respect of the land issued by a Government Department or Public Authority in relation to livestock disease or contamination by agricultural chemicals affecting the ongoing use of the land for agricultural purposes.
- (c) Particulars of any Notice of intention to acquire served under Section 6 of the *Land Acquisition and Compensation Act, 1986* are: Not Applicable

32E BUILDING PERMITS

Particulars of any Building Permit issued under the *Building Act 1993* during the past seven years (where there is a residence on the land):-

No such Building Permit has been granted to the Vendors knowledge.

32F OWNERS CORPORATION

The Land is NOT affected by an Owners Corporation within the meaning of the *Owners Corporation Act 2006*.

32G GROWTH AREAS INFRASTRUCTURE CONTRIBUTION (GAIC)

The land, in accordance with a work-in-kind agreement (within the meaning of Part 9B of the *Planning and Environment Act 1987* is NOT –

- land that is to be transferred under the agreement.
- land on which works are to be carried out under the agreement (other than Crown land).
- land in respect of which a GAIC is imposed

SECTION 32 STATEMENT
8 MOSCRIPT STREET CAMPBELLS CREEK VIC 3451

32H SERVICES

Service	Status
Electricity supply	Connected
Gas supply	Connected
Water supply	Connected
Sewerage	Connected
Telephone services	Connected

Connected indicates that the service is provided by an authority and operating on the day of sale. The Purchaser should be aware that the Vendor may terminate their account with the service provider before settlement, and the purchaser will have to have the service reconnected.

32I TITLE

Attached are the following document/s concerning Title:

- (a) In the case of land under the *Transfer of Land Act 1958* a copy of the Register Search Statement/s and the document/s, or part of the document/s, referred to as the diagram location in the Register Search Statement/s that identifies the land and its location.
- (b) In any other case, a copy of -
 - (i) the last conveyance in the Chain of Title to the land; or
 - (ii) any other document which gives evidence of the Vendors title to the land.
- (c) Where the Vendor is not the registered proprietor or the owner of the estate in fee simple, copies of the documents bearing evidence of the Vendor's right or power to sell the land.
- (d) In the case of land that is subject to a subdivision -
 - (i) a copy of the Plan of Subdivision which has been certified by the relevant municipal council (if the Plan of Subdivision has not been registered), or
 - (ii) a copy of the latest version of the plan (if the Plan of Subdivision has not been certified).
- (e) In the case of land that is part of a staged subdivision within the meaning of Section 37 of the *Subdivision Act 1988* -
 - (i) if the land is in the second or a subsequent stage, a copy of the plan for the first stage; and
 - (ii) details of any requirements in a Statement of Compliance relating to the stage in which the land is included that have not been complied with; and
 - (iii) details of any proposals relating to subsequent stages that are known to the Vendor; and
 - (iv) a statement of the contents of any permit under the *Planning and Environment Act 1987* authorising the staged subdivision.
- (f) In the case of land that is subject to a subdivision and in respect of which a further plan within the meaning of the *Subdivision Act 1988* is proposed -
 - (i) if the later plan has not been registered, a copy of the plan which has been certified by the relevant municipal council; or
 - (ii) if the later plan has not yet been certified, a copy of the latest version of the plan.

SECTION 32 STATEMENT
8 MOSCRIPT STREET CAMPBELLS CREEK VIC 3451

DATE OF THIS STATEMENT

	/		/20	
--	---	--	-----	--

Name of the Vendor

Andrew William Moffat

Signature/s of the Vendor

x *Griffin Conveyancing*

Signed by Griffin Conveyancing as agent for Vendor

The Purchaser acknowledges being given a duplicate of this statement signed by the Vendor before the Purchaser signed any contract.

DATE OF THIS ACKNOWLEDGMENT

	/		/20	
--	---	--	-----	--

Name of the Purchaser

--

Signature/s of the Purchaser

x

IMPORTANT NOTICE - ADDITIONAL DISCLOSURE REQUIREMENTS

Undischarged mortgages – S32A(a)

Where the land is to be sold subject to a mortgage (registered or unregistered) which is not to be discharged before the purchaser becomes entitled to possession or receipt of rents and profits, then the vendor must provide an additional statement including the particulars specified in Schedule 1 of the *Sale of Land Act 1962*.

Terms contracts – S32A(d)

Where the land is to be sold pursuant to a terms contract which obliges the purchaser to make two or more payments to the vendor after execution of the contract and before the vendor is entitled to a conveyance or transfer, then the vendor must provide an additional statement containing the information specified in Schedule 2 of the *Sale of Land Act 1962*.

Register Search Statement - Volume 8097 Folio 527

Copyright State of Victoria. This publication is copyright. No part may be reproduced by any process except in accordance with the provisions of the Copyright Act 1968 (Cth) and for the purposes of Section 32 of the Sale of Land Act 1962 (Vic) or pursuant to a written agreement. The information is only valid at the time and in the form obtained from the LANDATA REGD TM System. The State of Victoria accepts no responsibility for any subsequent release, publication or reproduction of the information.

REGISTER SEARCH STATEMENT (Title Search) Transfer of Land Act 1958

VOLUME 08097 FOLIO 527

Security no : 124068695429J
Produced 20/10/2017 12:13 pm

LAND DESCRIPTION

Lot 2 on Plan of Subdivision 032261.
PARENT TITLE Volume 08042 Folio 425
Created by instrument 2695739 15/12/1954

REGISTERED PROPRIETOR

Estate Fee Simple
Sole Proprietor
ANDREW WILLIAM MOFFAT of 8 MOSCRIPT STREET CAMPBELLS CREEK VIC 3451
AL659338S 04/02/2015

ENCUMBRANCES, CAVEATS AND NOTICES

Any encumbrances created by Section 98 Transfer of Land Act 1958 or Section 24 Subdivision Act 1988 and any other encumbrances shown or entered on the plan or imaged folio set out under DIAGRAM LOCATION below.

DIAGRAM LOCATION

SEE LP032261 FOR FURTHER DETAILS AND BOUNDARIES

ACTIVITY IN THE LAST 125 DAYS

NIL

-----END OF REGISTER SEARCH STATEMENT-----

Additional information: (not part of the Register Search Statement)

Street Address: 8 MOSCRIPT STREET CAMPBELLS CREEK VIC 3451

DOCUMENT END

**Delivered from the Landata ® System by SAI Global Property Division Pty Ltd
Delivered at 20/10/2017, for Order Number 47291328. Your reference: vmofmos.**

L.P. 32261

LP 32261
EDITION I

PLAN OF SUBDIVISION OF
PART OF CROWN ALLOT. 22, SEC. 1^A.
PARISH OF CASTLEMAINE
COUNTY OF TALBOT

Sheet 10

Ref. No. P918

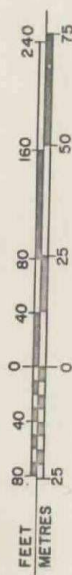

The Land Coloured Blue is Appropriated or Set Apart for Easement of Drainage 6' Wide

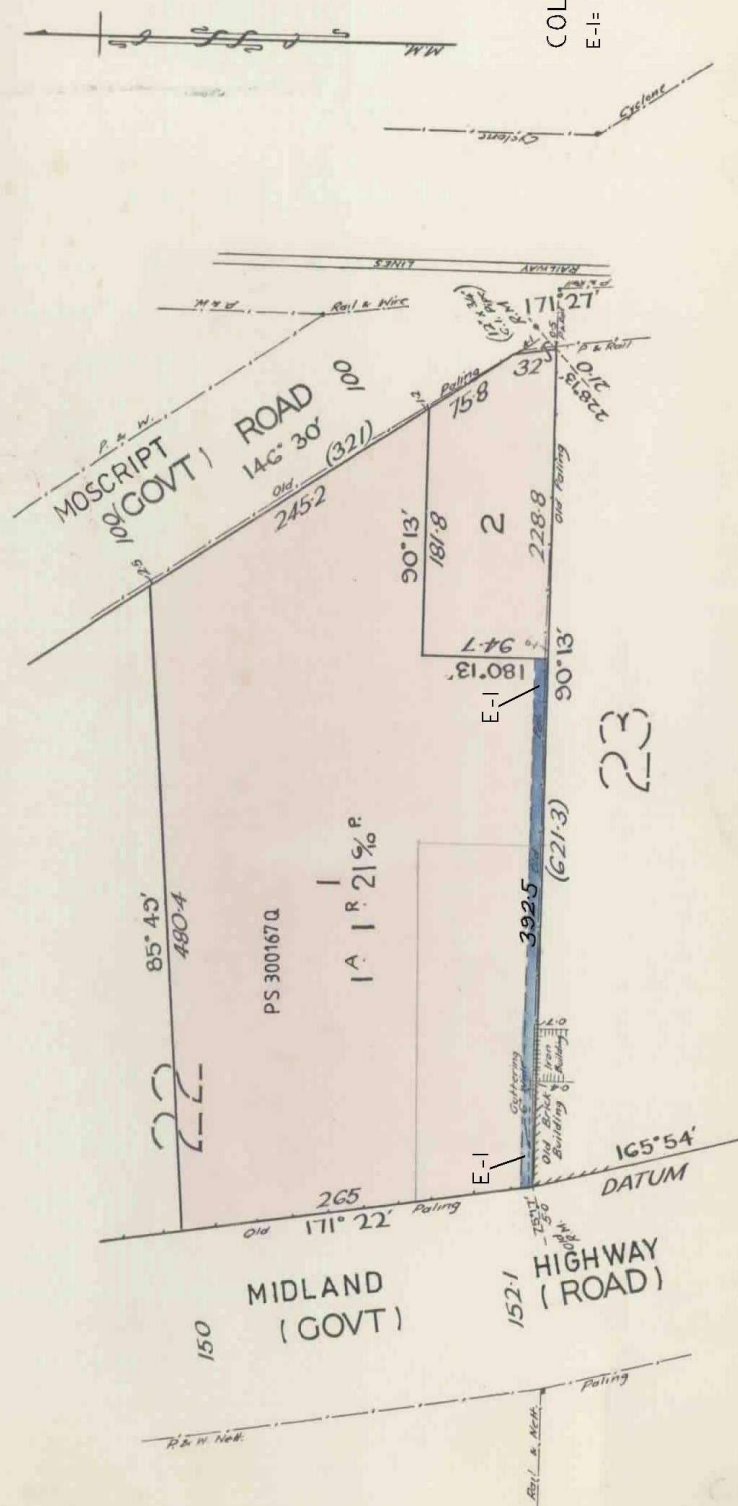

COLOUR CODE
E-1= BLUE

FOR APPROPRIATIONS ETC.
SEE BACK HEREOF

FOR APPROPRIATIONS, ETC.
SEE BACK HEREOF

L.P. 32261

Property Report from www.land.vic.gov.au on 20 October 2017 12:20 PM

Address: 8 MOSCRIPT STREET CAMPBELLS CREEK 3451

Lot and Plan Number: Lot 2 LP32261

Standard Parcel Identifier (SPI): 2\LP32261

Local Government (Council): MOUNT ALEXANDER **Council Property Number:** 4334

Directory Reference: VicRoads 59 E3

This property is in a designated bushfire prone area.

Special bushfire construction requirements apply. Planning provisions may apply.

Further information about the building control system and building in bushfire prone areas can be found in the Building Commission section of the Victorian Building Authority website www.vba.vic.gov.au

State Electorates

Legislative Council: NORTHERN VICTORIA

Legislative Assembly: BENDIGO WEST

Utilities

Regional Urban Water Business: Coliban Region Water

Rural Water Business: Goulburn-Murray Water

Melbourne Water: outside drainage boundary

Power Distributor: POWERCOR (Information about [choosing an electricity retailer](#))

Planning Zone Summary

Planning Zone: TOWNSHIP ZONE (TZ)
SCHEDULE TO THE TOWNSHIP ZONE (TZ)

Planning Overlay: None

Areas of Aboriginal Cultural Heritage Sensitivity:

This property is within, or affected by, one or more areas of cultural heritage sensitivity

Planning information continued on next page

Planning scheme data last updated on 18 October 2017.

A **planning scheme** sets out policies and requirements for the use, development and protection of land. This report provides information about the zone and overlay provisions that apply to the selected land. Information about the State, local, particular and general provisions of the local planning scheme that may affect the use of this land can be obtained by contacting the local council or by visiting [Planning Schemes Online](#)

This report is NOT a **Planning Certificate** issued pursuant to Section 199 of the Planning & Environment Act 1987. It does not include information about exhibited planning scheme amendments, or zonings that may affect the land. To obtain a Planning Certificate go to [Titles and Property Certificates](#)

The Planning Property Report includes separate maps of zones and overlays

For details of surrounding properties, use this service to get the Reports for properties of interest

To view planning zones, overlay and heritage information in an interactive format visit [Planning Maps Online](#)

For other information about planning in Victoria visit www.planning.vic.gov.au

Areas of Aboriginal Cultural Heritage Sensitivity

The data provides indicative information about the location and extent of areas of Aboriginal cultural heritage sensitivity and is provided to assist with the decisions about the potential need to prepare a Cultural Heritage Management Plan in relation to proposed activities on this property.

For further information about whether a Cultural Heritage Management Plan is required go to [Aboriginal Heritage Planning Tool](#)

To find out if your property has any recorded Aboriginal cultural heritage places, such as scarred trees, occupation sites or places of burial, you can request information from the Victorian Aboriginal Heritage Register.

Find out more about the [Victorian Aboriginal Heritage Register](#)

Area Map

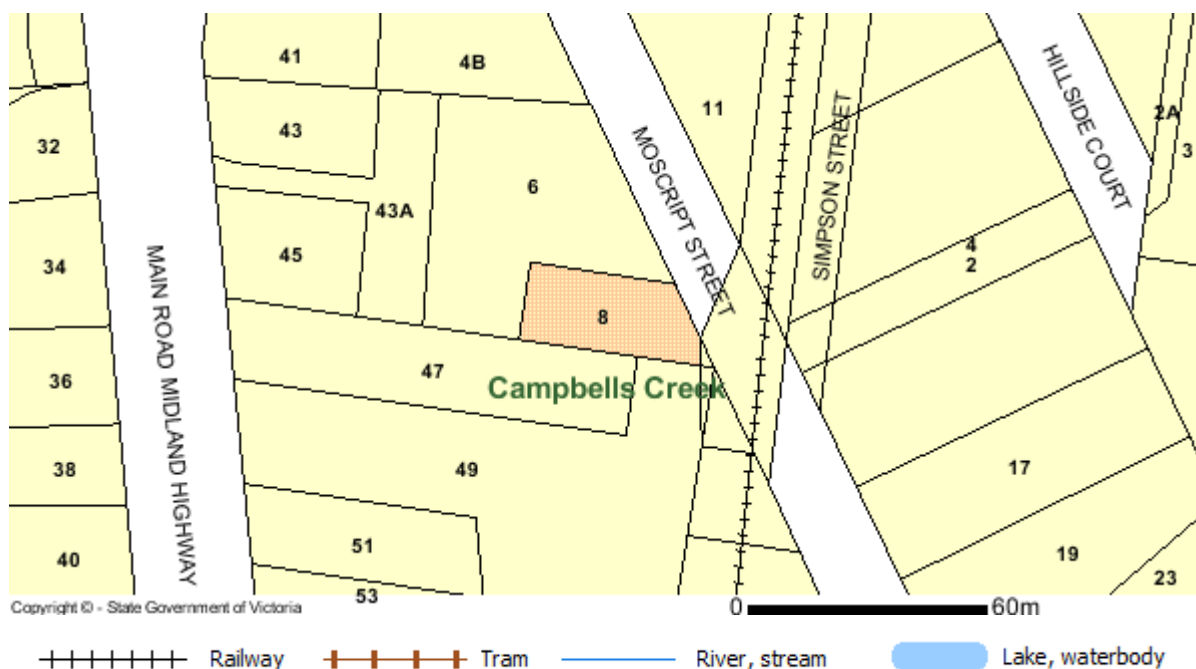

Copyright © - State Government of Victoria

Disclaimer: This content is provided for information purposes only. No claim is made as to the accuracy or authenticity of the content. The Victorian Government does not accept any liability to any person for the information provided.

Read the full disclaimer at www.land.vic.gov.au/home/copyright-and-disclaimer

TAX INVOICE



033

**A W Moffat
8 Moscript St
CAMPBELLS CREEK VIC 3451**

Account Number

23-0406-1200-01-0

Invoice Number

6783851

We will debit

\$ 186.84

As authorised from your
nominated account on:

16 December 2016

Service Address: 8 Moscript St, Campbells Creek VIC 3451

Classification: Residential

See over the page for payment options

Balance Brought Forward

Opening Balance	\$172.95
Total Payments Received up to 17 Nov 2016	\$172.95 CR
Balance	\$0.00

Current Charges

Water Consumption	\$33.13
Water Service Fee	\$58.24
Sewerage Service Fee	\$174.99
Concession Entitlement	\$79.52 CR
Total	\$186.84

Total Amount Due

Total includes GST of	\$0.00
------------------------------	---------------

Concession has been applied.

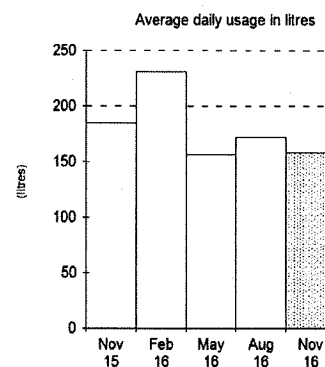

Av. Daily Use 157 L/day

Av. Daily Cost \$1.97/day

- Please contact us on 1300 363 200 if you have a concern about your water or sewer service. If we are unable to resolve your concern you can contact the Energy and Water Ombudsman (Victoria) on freecall 1800 500 509. Refer to www.ewov.com.au for more information

Permanent Water Saving Rules

5 simple rules are in place at all times when water restrictions are not in force.

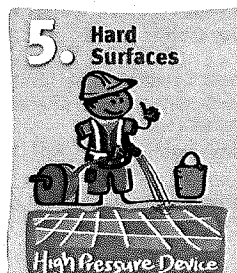
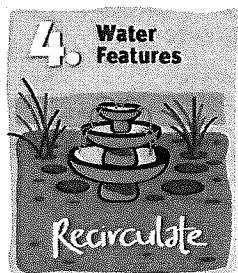
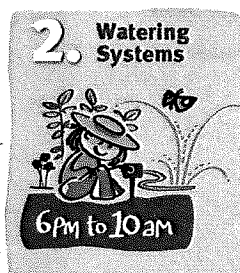
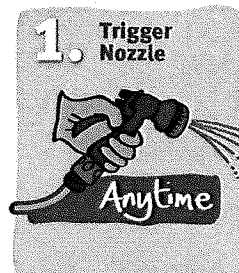

To find out more visit www.savingwater.com.au or call **1300 363 200** for further information

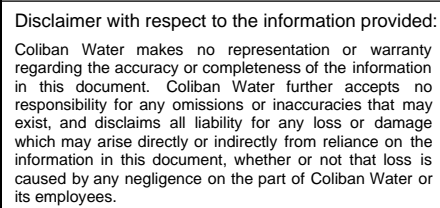

8 Moscript St Campbells Creek



Coliban
WATER

Date: 20/10/2017

Due Diligence Checklist

What you need to know before buying a residential property

Before you buy a home, you should be aware of a range of issues that may affect that property and impose restrictions or obligations on you, if you buy it. This checklist aims to help you identify whether any of these issues will affect you. The questions are a starting point only and you may need to seek professional advice to answer some of them. You can find links to organisations and web pages that can help you learn more, by visiting consumer.vic.gov.au/duediligencechecklist.

Urban living

Moving to the inner city?

High density areas are attractive for their entertainment and service areas, but these activities create increased traffic as well as noise and odours from businesses and people. Familiarising yourself with the character of the area will give you a balanced understanding of what to expect.

Is the property subject to an owners corporation?

If the property is part of a subdivision with common property such as driveways or grounds, it may be subject to an owners corporation. You may be required to pay fees and follow rules that restrict what you can do on your property, such as a ban on pet ownership.

Growth areas

Are you moving to a growth area?

You should investigate whether you will be required to pay a growth areas infrastructure contribution.

Flood and fire risk

Does this property experience flooding or bushfire?

Properties are sometimes subject to the risk of fire and flooding due to their location. You should properly investigate these risks and consider their implications for land management, buildings and insurance premiums.

Rural properties

Moving to the country?

If you are looking at property in a rural zone, consider:

- Is the surrounding land use compatible with your lifestyle expectations? Farming can create noise or odour that may be at odds with your expectations of a rural lifestyle.
- Are you considering removing native vegetation? There are regulations which affect your ability to remove native vegetation on private property.
- Do you understand your obligations to manage weeds and pest animals?
- Can you build new dwellings?
- Does the property adjoin crown land, have a water frontage, contain a disused government road, or are there any crown licences associated with the land?

Is there any earth resource activity such as mining in the area?

You may wish to find out more about exploration, mining and quarrying activity on or near the property and consider the issue of petroleum, geothermal and greenhouse gas sequestration permits, leases and licences, extractive industry authorisations and mineral licences.

Soil and groundwater contamination

Has previous land use affected the soil or groundwater?

You should consider whether past activities, including the use of adjacent land, may have caused contamination at the site and whether this may prevent you from doing certain things to or on the land in the future.

Land boundaries

Do you know the exact boundary of the property?

You should compare the measurements shown on the title document with actual fences and buildings on the property, to make sure the boundaries match. If you have concerns about this, you can speak to your lawyer or conveyancer, or commission a site survey to establish property boundaries.

Planning controls

Can you change how the property is used, or the buildings on it?

All land is subject to a planning scheme, run by the local council. How the property is zoned and any overlays that may apply, will determine how the land can be used. This may restrict such things as whether you can build on vacant land or how you can alter or develop the land and its buildings over time.

The local council can give you advice about the planning scheme, as well as details of any other restrictions that may apply, such as design guidelines or bushfire safety design. There may also be restrictions – known as encumbrances – on the property's title, which prevent you from developing the property. You can find out about encumbrances by looking at the section 32 statement.

Are there any proposed or granted planning permits?

The local council can advise you if there are any proposed or issued planning permits for any properties close by. Significant developments in your area may change the local 'character' (predominant style of the area) and may increase noise or traffic near the property.

Safety

Is the building safe to live in?

Building laws are in place to ensure building safety. Professional building inspections can help you assess the property for electrical safety, possible illegal building work, adequate pool or spa fencing and the presence of asbestos, termites, or other potential hazards.

Building permits

Have any buildings or retaining walls on the property been altered, or do you plan to alter them?

There are laws and regulations about how buildings and retaining walls are constructed, which you may wish to investigate to ensure any completed or proposed building work is approved. The local council may be able to give you information about any building permits issued for recent building works done to the property, and what you must do to plan new work. You can also commission a private building surveyor's assessment.

Are any recent building or renovation works covered by insurance?

Ask the vendor if there is any owner-builder insurance or builder's warranty to cover defects in the work done to the property.

Utilities and essential services

Does the property have working connections for water, sewerage, electricity, gas, telephone and internet?

Unconnected services may not be available, or may incur a fee to connect. You may also need to choose from a range of suppliers for these services. This may be particularly important in rural areas where some services are not available.

Buyers' rights

Do you know your rights when buying a property?

The contract of sale and section 32 statement contain important information about the property, so you should request to see these and read them thoroughly. Many people engage a lawyer or conveyancer to help them understand the contracts and ensure the sale goes through correctly. If you intend to hire a professional, you should consider speaking to them before you commit to the sale. There are also important rules about the way private sales and auctions are conducted. These may include a cooling-off period and specific rights associated with 'off the plan' sales. The important thing to remember is that, as the buyer, you have rights