

WESTERN



AUSTRALIA

TITLE NUMBER

Volume Folio

2816 779

RECORD OF CERTIFICATE OF TITLE
UNDER THE TRANSFER OF LAND ACT 1893

The person described in the first schedule is the registered proprietor of an estate in fee simple in the land described below subject to the reservations, conditions and depth limit contained in the original grant (if a grant issued) and to the limitations, interests, encumbrances and notifications shown in the second schedule.

BGRoberts
REGISTRAR OF TITLES



LAND DESCRIPTION:

LOT 2 ON DEPOSITED PLAN 71481

REGISTERED PROPRIETOR:
(FIRST SCHEDULE)

(T M359294) REGISTERED 1/8/2013

LIMITATIONS, INTERESTS, ENCUMBRANCES AND NOTIFICATIONS:
(SECOND SCHEDULE)

1. EASEMENT BURDEN CREATED UNDER SECTION 167 P. & D. ACT FOR SEWERAGE PURPOSES TO WATER CORPORATION - SEE DEPOSITED PLAN 71481
2. N705372 MORTGAGE TO AUSTRALIA & NEW ZEALAND BANKING GROUP LTD REGISTERED 28/8/2017.

Warning: A current search of the sketch of the land should be obtained where detail of position, dimensions or area of the lot is required.
Lot as described in the land description may be a lot or location.

-----END OF CERTIFICATE OF TITLE-----

STATEMENTS:

The statements set out below are not intended to be nor should they be relied on as substitutes for inspection of the land and the relevant documents or for local government, legal, surveying or other professional advice.

SKETCH OF LAND: DP71481
PREVIOUS TITLE: 1644-803
PROPERTY STREET ADDRESS: 38 QUICKLY CR, HAMILTON HILL.
LOCAL GOVERNMENT AUTHORITY: CITY OF COCKBURN

TYPE	FREEHOLD
PURPOSE	SUBDIVISION
PLAN OF	LOTS 1, 2 AND EASEMENT
DISTRICT	COCKBURN SOUND
TOWNSITE	CITY OF COCKBURN
LOCAL AUTHORITY	HAMILTON HILL
LOCALITY	FORMER TENURE
FORMER TENURE	LOT 651 ON D 64557
INDEX	BG34(2) 9.09
PUBLIC	122471
SCALE	1: 250 AT A3 SIZE
ALL DISTANCES ARE IN METRES	0 5 10 15
SURVEYOR'S CERTIFICATE - Reg 84	SURVEYOR'S CERTIFICATE - Completed
I, DENNIS HAYES hereby certify that this plan is accurate and is a correct representation of the land shown.	I, DENNIS HAYES hereby certify that this compiled plan (a) is a correct and accurate representation of the survey(s) of the subject land; and (b) is in accordance with the relevant law in relation to which it is lodged.
DATE	2/11/2012
Licensed Surveyor	DENNIS Wm. HAYES & ASSOCIATES
Address	5 Merrifield Place, WILLOWBROOK W.A. 6027
Phone	(08) 9401 4994
APPROVED BY	WESTERN AUSTRALIAN PLANNING COMMISSION
FILE	145584
DATE	31-May-2013
Delegated Under Sec. 16 of the P & D Act 2005	

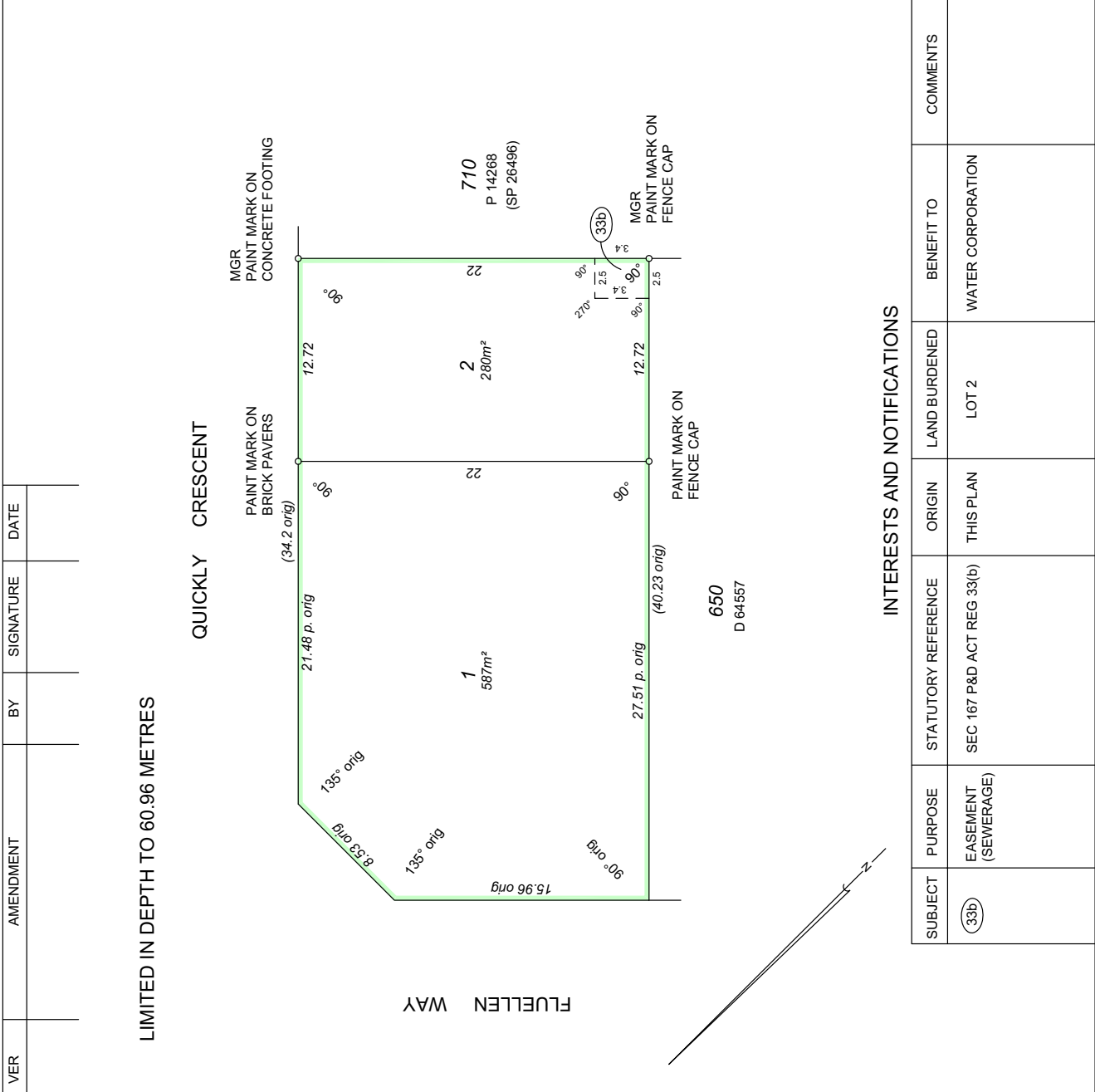

VER	AMENDMENT	BY	SIGNATURE	DATE

INTERESTS AND NOTIFICATIONS						
SUBJECT	PURPOSE	STATUTORY REFERENCE	ORIGIN	LAND BURDENED	BENEFIT TO	COMMENTS
33b	EASEMENT (SEWERAGE)	SEC 167 P&D ACT REG 33(b)	THIS PLAN	LOT 2	WATER CORPORATION	

Deposited Plan 71481

Lot	Certificate of Title	Lot Status	Part Lot
1	2816/778	Registered	
2	2816/779	Registered	