

Statement of Information

Single residential property located in the Melbourne metropolitan area

Section 47AF of the Estate Agents Act 1980

Property offered for sale

Address Including suburb and postcode 25 Corymbia Grove, South Morang Vic 3752

Indicative selling price

For the meaning of this price see consumer.vic.gov.au/underquoting

Single price \$440,000

Median sale price

Median price \$596,500 House X Unit Suburb South Morang

Period - From 01/04/2019 to 30/06/2019 Source REIV

Comparable property sales (*Delete A or B below as applicable)

~~A* These are the three properties sold within two kilometres of the property for sale in the last six months that the estate agent or agent's representative considers to be most comparable to the property for sale.~~

Address of comparable property	Price	Date of sale
1		
2		
3		

OR

~~B* The estate agent or agent's representative reasonably believes that fewer than three comparable properties were sold within two kilometres of the property for sale in the last six months.~~

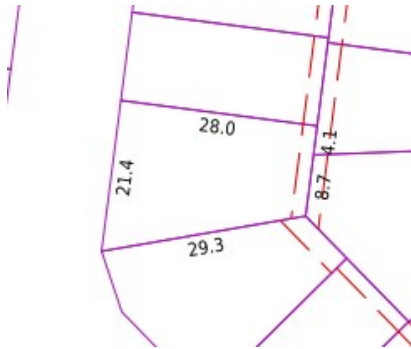

Rooms:
Property Type: Land
Land Size: 478 sqm approx
Agent Comments

Indicative Selling Price
\$440,000
Median House Price
June quarter 2019: \$596,500

Comparable Properties

The estate agent or agent's representative reasonably believes that fewer than three comparable properties were sold within two kilometres of the property for sale in the last six months.