

## Statement of Information

# Single residential property located outside the Melbourne metropolitan area

Section 47AF of the Estate Agents Act 1980

### Property offered for sale

Address  
Including suburb and  
postcode

12 FREDRICK STREET DARLEY VIC 3340

### Indicative selling price

For the meaning of this price see [consumer.vic.gov.au/underquoting](http://consumer.vic.gov.au/underquoting) (\*Delete single price or range as applicable)

Single Price

or range  
between

\$449,000

&

\$493,000

### Median sale price

(\*Delete house or unit as applicable)

Median Price

\$370,000

Property type

Land

Suburb

Darley

Period-from

01 Jun 2021

to

31 May 2022

Source

Corelogic

### Comparable property sales (\*Delete A or B below as applicable)

**A\*** These are the three properties sold within five kilometres of the property for sale in the last 18 months that the estate agent or agent's representative considers to be most comparable to the property for sale.

Address of comparable property

Price

Date of sale

28 GUM TREE TERRACE DARLEY VIC 3340	\$340,000	29-Nov-21
2 HOLMAN CRESCENT BACCHUS MARSH VIC 3340	\$300,000	23-Dec-21
4 VALENTINA DRIVE DARLEY VIC 3340	\$280,000	07-Mar-22

OR

**B\*** The estate agent or agent's representative reasonably believes that fewer than three comparable properties were sold within five kilometres of the property for sale in the last 18 months.

This Statement of Information was prepared on: 02 June 2022



### 28 GUM TREE TERRACE DARLEY VIC 3340

 -  -  -

Sold Price **\$340,000** Sold Date **29-Nov-21**

Distance -



### 2 HOLMAN CRESCENT BACCHUS MARSH VIC 3340

 -  -  -

Sold Price <sup>RS</sup> **\$300,000** <sup>UN</sup> Sold Date **23-Dec-21**

Distance -



### 4 VALENTINA DRIVE DARLEY VIC 3340

 -  -  2

Sold Price **\$280,000** Sold Date **07-Mar-22**

Distance **0.77km**



### 19 DARLEY DRIVE DARLEY VIC 3340

 -  -  2

Sold Price **\$370,000** Sold Date **14-Jan-22**

Distance -



### 42 GRANDVIEW CRESCENT DARLEY VIC 3340

 -  -  -

Sold Price <sup>RS</sup> **\$346,000** Sold Date **23-Feb-22**

Distance **0.26km**



### 126A HALLETTS WAY DARLEY VIC 3340

 -  -  -

Sold Price **\$470,000** Sold Date **15-Dec-21**

Distance **0.61km**

RS = Recent sale UN = Undisclosed Sale

**DISCLAIMER** Whilst all reasonable effort is made to ensure the information in this publication is current, CoreLogic does not warrant the accuracy or completeness of the data and information contained in this publication and to the full extent not prohibited by law excludes all for any loss or damage arising in connection with the data and information contained in this publication.

The State of Victoria owns the copyright in the Property Sales Data and reproduction of that data in any way without the consent of the State of Victoria will constitute a breach of the Copyright Act 1968 (Cth). The State of Victoria does not warrant the accuracy or completeness of the Property Sales Data and any person using or relying upon such information does so on the basis that the State of Victoria accepts no responsibility or liability whatsoever for any errors, faults, defects or omissions in the information supplied.



#### 4 HOLMAN CRESCENT BACCHUS MARSH VIC 3340

Sold Price <sup>RS</sup> **\$330,000** <sup>UN</sup> Sold Date **23-Dec-21**

 -  -  -

Distance -



#### 25 FREDRICK STREET DARLEY VIC 3340

Sold Price **\$423,500** Sold Date **17-Mar-21**

 -  -  -

Distance **0.06km**

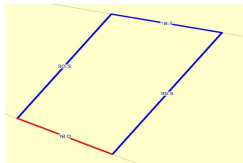

#### 3 OSWIN STREET MADDINGLEY VIC 3340

Sold Price **\$425,000** Sold Date **11-Feb-22**

 4  1  2

Distance **2.53km**



#### 15 HARTOG GROVE DARLEY VIC 3340

Sold Price **\$561,000** Sold Date **21-Nov-21**

 -  -  -

Distance **2.51km**

RS = Recent sale UN = Undisclosed Sale

**DISCLAIMER** Whilst all reasonable effort is made to ensure the information in this publication is current, CoreLogic does not warrant the accuracy or completeness of the data and information contained in this publication and to the full extent not prohibited by law excludes all for any loss or damage arising in connection with the data and information contained in this publication.

The State of Victoria owns the copyright in the Property Sales Data and reproduction of that data in any way without the consent of the State of Victoria will constitute a breach of the Copyright Act 1968 (Cth). The State of Victoria does not warrant the accuracy or completeness of the Property Sales Data and any person using or relying upon such information does so on the basis that the State of Victoria accepts no responsibility or liability whatsoever for any errors, faults, defects or omissions in the information supplied.