

Statement of Information

Single residential property located in the Melbourne metropolitan area

Section 47AF of the Estate Agents Act 1980

Property offered for sale

Address
Including suburb and
postcode

9 Eucalyptus Road, Eltham Vic 3095

Indicative selling price

For the meaning of this price see consumer.vic.gov.au/underquoting

Range between \$1,910,000

&

\$2,101,000

Median sale price

Median price \$985,500

House

X

Unit

Suburb Eltham

Period - From 01/10/2017

to

31/12/2017

Source REIV

Comparable property sales (*Delete A or B below as applicable)

~~A* These are the three properties sold within two kilometres of the property for sale in the last six months that the estate agent or agent's representative considers to be most comparable to the property for sale.~~

Address of comparable property	Price	Date of sale
1		
2		
3		

OR

B* The estate agent or agent's representative reasonably believes that fewer than three comparable properties were sold within two kilometres of the property for sale in the last six months.

Jason Stepanow

9842 8888

0405 159 650

jstepanow@barryplant.com.au

Indicative Selling Price

\$1,910,000 - \$2,101,000

Median House Price

December quarter 2017: \$985,500

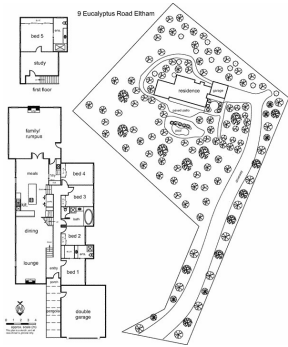

 5  3  2

Rooms:

Property Type: House (Res)

Land Size: 6783 sqm approx

Agent Comments

Comparable Properties

The estate agent or agent's representative reasonably believes that fewer than three comparable properties were sold within two kilometres of the property for sale in the last six months.