

## Statement of Information

## Single residential property located in the Melbourne metropolitan area

Section 47AF of the Estate Agents Act 1980

## Property offered for sale

Address  
Including suburb and  
postcode

4/238 Greenslopes Drive, Templestowe Lower Vic 3107

## Indicative selling price

For the meaning of this price see [consumer.vic.gov.au/underquoting](http://consumer.vic.gov.au/underquoting)

Single price \$599,500

## Median sale price

Median price \$766,000

House

Unit

X

Suburb

Templestowe  
Lower

Period - From 01/10/2016

to

30/09/2017

Source REIV

## Comparable property sales (\*Delete A or B below as applicable)

**A\*** These are the three properties sold within two kilometres of the property for sale in the last six months that the estate agent or agent's representative considers to be most comparable to the property for sale.

Address of comparable property	Price	Date of sale
1		
2		
3		

OR

**B\*** The estate agent or agent's representative reasonably believes that fewer than three comparable properties were sold within two kilometres of the property for sale in the last six months.

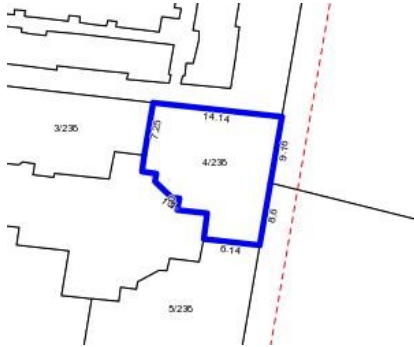

**Rooms:** 4

**Property Type:** Strata Unit/Flat

**Land Size:** 208.10 sqm approx

Agent Comments

**Indicative Selling Price**

\$599,500

**Median Unit Price**

Year ending September 2017: \$766,000

## Comparable Properties

The estate agent or agent's representative reasonably believes that fewer than three comparable properties were sold within two kilometres of the property for sale in the last six months.