

Statement of Information

Single residential property located in the Melbourne metropolitan area

Section 47AF of the Estate Agents Act 1980

Property offered for sale

Address
Including suburb and
postcode

1A Teal Court, Forest Hill Vic 3131

Indicative selling price

For the meaning of this price see consumer.vic.gov.au/underquoting

Range between \$880,000

&

\$960,000

Median sale price

Median price \$1,231,000

Property Type House

Suburb Forest Hill

Period - From 17/08/2021

to

16/08/2022

Source REIV

Comparable property sales (*Delete A or B below as applicable)

~~A* These are the three properties sold within two kilometres of the property for sale in the last six months that the estate agent or agent's representative considers to be most comparable to the property for sale.~~

Address of comparable property	Price	Date of sale
1		
2		
3		

OR

~~B* The estate agent or agent's representative reasonably believes that fewer than three comparable properties were sold within two kilometres of the property for sale in the last six months.~~

This Statement of Information was prepared on:

17/08/2022 13:42

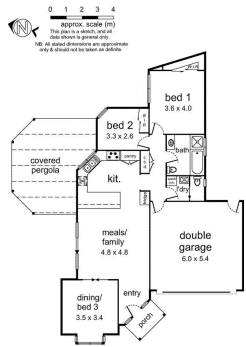

Property Type: Subdivided
Unit/Villa/Townhouse - Single OYO
Dwelling
Agent Comments

Indicative Selling Price

\$880,000 - \$960,000

Median House Price

17/08/2021 - 16/08/2022: \$1,231,000

Comparable Properties

The estate agent or agent's representative reasonably believes that fewer than three comparable properties were sold within two kilometres of the property for sale in the last six months.

Account - Harcourts Vermont South | P: 03 98861008