

Statement of Information

Single residential property located in the Melbourne metropolitan area

Section 47AF of the Estate Agents Act 1980

Property offered for sale

Address
Including suburb and
postcode

15/8 Maury Road Chelsea VIC 3196

Indicative selling price

For the meaning of this price see consumer.vic.gov.au/underquoting (*Delete single price or range as applicable)

Single Price

or range
between

\$480,000

&

\$520,000

Median sale price

(*Delete house or unit as applicable)

Median Price

\$651,600

Property type

Unit

Suburb

Chelsea

Period-from

01 Jul 2020

to

30 Jun 2021

Source

Corelogic

Comparable property sales (*Delete A or B below as applicable)

A* These are the three properties sold within two kilometres of the property for sale in the last 6 months that the estate agent or agent's representative considers to be most comparable to the property for sale.

Address of comparable property

Price

Date of sale

14/8 Maury Road Chelsea VIC 3196	\$530,000	21-Jun-21
17/334-339 Station Street Chelsea VIC 3196	\$520,000	25-May-21
5/533-535 Nepean Highway Bonbeach VIC 3196	\$525,000	23-Feb-21

OR

B* ~~The estate agent or agent's representative reasonably believes that fewer than three comparable properties were sold within two kilometres of the property for sale in the last 6 months.~~

This Statement of Information was prepared on: 12 July 2021



OBrien Real Estate

Tanja Neven - Jones

P 9772 7077

M 0408 664 429

E t.nevenjones@obrienrealestate.com.au

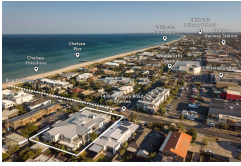

14/8 Maury Road Chelsea VIC 3196

Sold Price

^{RS} \$530,000 ^{UN}

Sold Date

21-Jun-21

2

1

1

Distance

-



17/334-339 Station Street Chelsea VIC 3196

Sold Price

\$520,000

Sold Date

25-May-21

2

1

1

Distance

0.41km

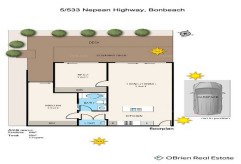

5/533-535 Nepean Highway Bonbeach VIC 3196

Sold Price

\$525,000

Sold Date

23-Feb-21

2

1

1

Distance

0.79km

RS = Recent sale

UN = Undisclosed Sale

DISCLAIMER Whilst all reasonable effort is made to ensure the information in this publication is current, CoreLogic does not warrant the accuracy or completeness of the data and information contained in this publication and to the full extent not prohibited by law excludes all for any loss or damage arising in connection with the data and information contained in this publication.

The State of Victoria owns the copyright in the Property Sales Data and reproduction of that data in any way without the consent of the State of Victoria will constitute a breach of the Copyright Act 1968 (Cth). The State of Victoria does not warrant the accuracy or completeness of the Property Sales Data and any person using or relying upon such information does so on the basis that the State of Victoria accepts no responsibility or liability whatsoever for any errors, faults, defects or omissions in the information supplied.