

Statement of Information

Single residential property located in the Melbourne metropolitan area

Section 47AF of the Estate Agents Act 1980

Property offered for sale

Address
Including suburb and
postcode

16a Premier Avenue, Vermont Vic 3133

Indicative selling price

For the meaning of this price see consumer.vic.gov.au/underquoting

Range between \$950,000 & \$1,020,000

Median sale price

Median price \$1,232,000 Property Type House Suburb Vermont

Period - From 01/10/2022 to 31/12/2022 Source REIV

Comparable property sales (*Delete A or B below as applicable)

A* These are the three properties sold within two kilometres of the property for sale in the last six months that the estate agent or agent's representative considers to be most comparable to the property for sale.

Address of comparable property		Price	Date of sale
1	68 Boronia Rd VERMONT 3133	\$1,020,000	16/12/2022
2	6 Coringa Cl VERMONT 3133	\$1,010,000	25/03/2023
3	4 Delatite Ct VERMONT 3133	\$960,000	22/01/2023

OR

~~**B*** The estate agent or agent's representative reasonably believes that fewer than three comparable properties were sold within two kilometres of the property for sale in the last six months.~~

This Statement of Information was prepared on:

13/04/2023 11:09

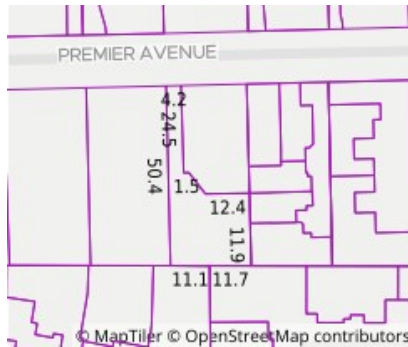

 3  2  3

Property Type: House
Land Size: 613 sqm approx
Agent Comments

Indicative Selling Price
\$950,000 - \$1,020,000
Median House Price
December quarter 2022: \$1,232,000

Comparable Properties



68 Boronia Rd VERMONT 3133 (REI/VG)

Agent Comments

 3  1  2

Price: \$1,020,000
Method: Private Sale
Date: 16/12/2022
Property Type: House
Land Size: 625 sqm approx



6 Coringa Ct VERMONT 3133 (REI)

Agent Comments

 3  1  2

Price: \$1,010,000
Method: Auction Sale
Date: 25/03/2023
Property Type: House (Res)
Land Size: 550 sqm approx

4 Delatite Ct VERMONT 3133 (VG)

Agent Comments

 3  -  -

Price: \$960,000
Method: Sale
Date: 22/01/2023
Property Type: House (Res)
Land Size: 535 sqm approx