

## Statement of Information

### Single residential property located in the Melbourne metropolitan area

Section 47AF of the Estate Agents Act 1980

#### Property offered for sale

Address Including suburb and postcode 106 Waterdale Road, Ivanhoe Vic 3079

#### Indicative selling price

For the meaning of this price see [consumer.vic.gov.au/underquoting](http://consumer.vic.gov.au/underquoting)

Range between \$610,000

&

\$660,000

#### Median sale price

Median price \$1,580,000

House

X

Unit

Suburb Ivanhoe

Period - From 01/01/2017

to

31/12/2017

Source REIV

#### Comparable property sales (\*Delete A or B below as applicable)

~~A\* These are the three properties sold within two kilometres of the property for sale in the last six months that the estate agent or agent's representative considers to be most comparable to the property for sale.~~

Address of comparable property	Price	Date of sale
1		
2		
3		

OR

B\* The estate agent or agent's representative reasonably believes that fewer than three comparable properties were sold within two kilometres of the property for sale in the last six months.

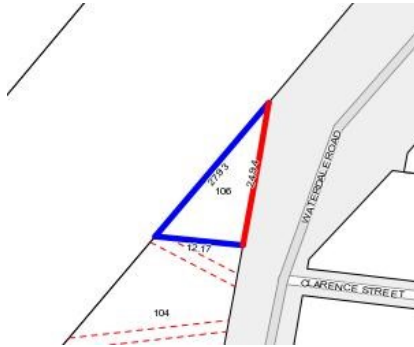

**Rooms:** 4  
**Property Type:** Building  
**Land Size:** 152 sqm approx  
**Agent Comments**

**Indicative Selling Price**  
\$610,000 - \$660,000  
**Median House Price**  
Year ending December 2017: \$1,580,000

## Comparable Properties

The estate agent or agent's representative reasonably believes that fewer than three comparable properties were sold within two kilometres of the property for sale in the last six months.