

Statement of Information

Single residential property located in the Melbourne metropolitan area

Section 47AF of the Estate Agents Act 1980

Property offered for sale

Address
Including suburb and
postcode

84 Lloyd Avenue, Reservoir Vic 3073

Indicative selling price

For the meaning of this price see consumer.vic.gov.au/underquoting

Range between

\$650,000

&

\$700,000

Median sale price

Median price

\$753,250

Property Type

House

Suburb

Reservoir

Period - From

01/07/2019

to

30/09/2019

Source

REIV

Comparable property sales (*Delete A or B below as applicable)

~~A* These are the three properties sold within two kilometres of the property for sale in the last six months that the estate agent or agent's representative considers to be most comparable to the property for sale.~~

Address of comparable property	Price	Date of sale
1		
2		
3		

OR

~~B* The estate agent or agent's representative reasonably believes that fewer than three comparable properties were sold within two kilometres of the property for sale in the last six months.~~

This Statement of Information was prepared on:

20/11/2019 15:12

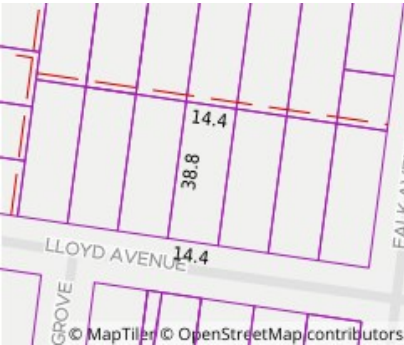

Property Type:
Agent Comments

Indicative Selling Price
\$650,000 - \$700,000
Median House Price
September quarter 2019: \$753,250

Comparable Properties

The estate agent or agent's representative reasonably believes that fewer than three comparable properties were sold within two kilometres of the property for sale in the last six months.