

STATEMENT OF INFORMATION

Section 47AF of the Estate Agents Act 1980

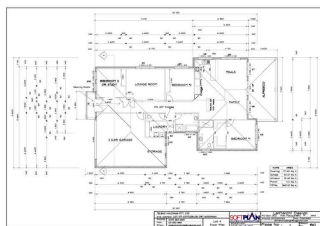

18 COTTLESLOE COURT, WEST

 3  2  2

Indicative Selling Price

For the meaning of this price see consumer.vic.au/underquoting

Single Price: **\$460,000**

Provided by: Joshua Hill, Professionals Wodonga

MEDIAN SALE PRICE

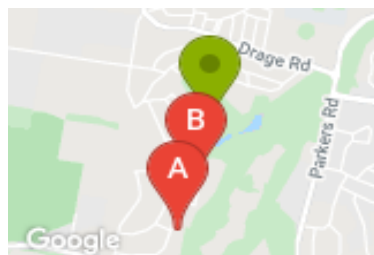

WEST WODONGA, VIC, 3690

Suburb Median Sale Price (House)

\$347,500

01 January 2019 to 31 December 2019

Provided by: 

COMPARABLE PROPERTIES

The estate agent or agent's representative reasonably believes that fewer than three comparable properties were sold within five kilometres of the property for sale in the last 18 months.



4 REEVE CRT, WEST WODONGA, VIC 3690

 3  2  6

Sale Price

\$450,000

Sale Date: 26/02/2019

Distance from Property: 786m



17 BIRKDALE TCE, WEST WODONGA, VIC 3690

 4  2  2

Sale Price

***\$463,000**

Sale Date: 20/02/2020

Distance from Property: 410m



Statement of Information

Single residential property located outside the Melbourne metropolitan area

Sections 47AF of the Estate Agents Act

Instructions: The instructions in this box do not form part of this Statement of Information and are not required to be included in the completed Statement of Information for the property being offered for sale.

The Director of Consumer Affairs Victoria has approved this form of the Statement of Information for section 47AF of the *Estate Agents Act 1980*.

The estate agent or agent's representative engaged to sell the property is required to prepare this Statement of Information. It must be used when **a single residential property located outside the Melbourne metropolitan area** is being offered for sale. The Determination setting out the local government areas that comprise the Melbourne metropolitan area is published on the Consumer Affairs Victoria website at **consumer.vic.gov.au/underquoting**.

The indicative selling price in this Statement of Information may be expressed as a single price, or as a price range with the difference between the upper and lower amounts not more than 10% of the lower amount.

This Statement of Information must be provided to a prospective buyer within two business days of a request and displayed at any open for inspection for the property for sale.

It is recommended that the address of the property being offered for sale be checked at services.land.vic.gov.au/landchannel/content/addressSearch before being entered in this Statement of Information.

Property offered for sale

Address
Including suburb and
postcode

18 COTTLESLOE COURT, WEST WODONGA, VIC 3690

Indicative selling price

For the meaning of this price see consumer.vic.gov.au/underquoting

Single Price:

\$460,000

Median sale price

Median price

\$347,500

Property type

House

Suburb

WEST WODONGA

Period

01 January 2019 to 31 December 2019

Source

 pricefinder

Comparable property sales

The estate agent or agent's representative reasonably believes that fewer than three comparable properties were sold within five kilometres of the property for sale in the last 18 months.

Address of comparable property

Price

Date of sale

4 REEVE CRT, WEST WODONGA, VIC 3690	\$450,000	26/02/2019
17 BIRKDALE TCE, WEST WODONGA, VIC 3690	*\$463,000	20/02/2020

This Statement of Information was prepared on:

19/03/2020