



# STATEMENT OF INFORMATION

6 PEAR TREE CLOSE, NORTH WONTHAGGI, VIC 3995

PREPARED BY PBE REAL ESTATE WONTHAGGI







## STATEMENT OF INFORMATION

Section 47AF of the Estate Agents Act 1980

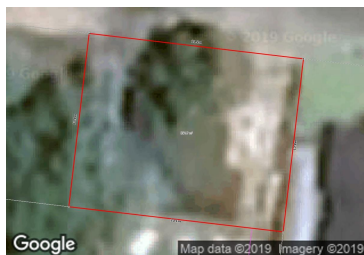

### 6 PEAR TREE CLOSE, NORTH

3 bedrooms 1 bathroom -

#### Indicative Selling Price

For the meaning of this price see [consumer.vic.au/underquoting](http://consumer.vic.au/underquoting)

Price Range: **\$390,000 to \$429,000**

## MEDIAN SALE PRICE

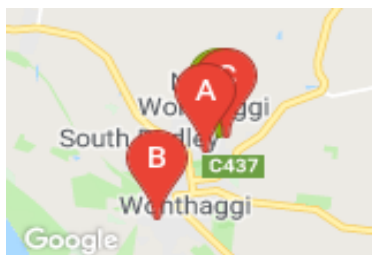

### NORTH WONTHAGGI, VIC, 3995

Suburb Median Sale Price (House)

**\$385,000**

01 October 2018 to 30 September 2019

Provided by: **pricefinder**

## COMPARABLE PROPERTIES

These are the three properties sold within five kilometres of the property for sale in the last 18 months that the estate agent or agent's representative considers to be most comparable to the property for sale.



### 1 KIRRAK ST, NORTH WONTHAGGI, VIC 3995

3 bedrooms 1 bathroom 2

Sale Price

**\$417,500**

Sale Date: 19/03/2019

Distance from Property: 537m



### 73 HAGELTHORN ST, WONTHAGGI, VIC 3995

2 bedrooms 1 bathroom 1

Sale Price

**\$370,000**

Sale Date: 06/04/2019

Distance from Property: 2.9km



### 24 PEAR TREE CL, NORTH WONTHAGGI, VIC

3 bedrooms 2 bathrooms 2

Sale Price

**\$389,000**

Sale Date: 22/05/2019

Distance from Property: 152m



This report has been compiled on 07/10/2019 by PBE Real Estate Wonthaggi. Property Data Solutions Pty Ltd 2019 - [www.pricefinder.com.au](http://www.pricefinder.com.au)

© The State of Victoria. The State of Victoria owns the copyright in the Property Sales Data and reproduction of the data in any way without the consent of the State of Victoria will constitute a breach of the Copyright Act 1968 (Cth). The State of Victoria does not warrant the accuracy or completeness of the information contained in this report and any person using or relying upon such information does so on the basis that the State of Victoria accepts no responsibility or liability whatsoever for any errors, faults, defects or omissions in the information supplied.

## Statement of Information

# Single residential property located outside the Melbourne metropolitan area

### Sections 47AF of the Estate Agents Act 1980

**Instructions:** The instructions in this box do not form part of this Statement of Information and are not required to be included in the completed Statement of Information for the property being offered for sale.

The Director of Consumer Affairs Victoria has approved this form of the Statement of Information for section 47AF of the *Estate Agents Act 1980*.

The estate agent or agent's representative engaged to sell the property is required to prepare this Statement of Information. It must be used when **a single residential property located outside the Melbourne metropolitan area** is being offered for sale. The Determination setting out the local government areas that comprise the Melbourne metropolitan area is published on the Consumer Affairs Victoria website at **consumer.vic.gov.au/underquoting**.

The indicative selling price in this Statement of Information may be expressed as a single price, or as a price range with the difference between the upper and lower amounts not more than 10% of the lower amount.

This Statement of Information must be provided to a prospective buyer within two business days of a request and displayed at any open for inspection for the property for sale.

It is recommended that the address of the property being offered for sale be checked at [services.land.vic.gov.au/landchannel/content/addressSearch](http://services.land.vic.gov.au/landchannel/content/addressSearch) before being entered in this Statement of Information.

### Property offered for sale

Address  
Including suburb and  
postcode

6 PEAR TREE CLOSE, NORTH WONTHAGGI, VIC 3995

### Indicative selling price

For the meaning of this price see [consumer.vic.gov.au/underquoting](http://consumer.vic.gov.au/underquoting)

Price Range:

\$390,000 to \$429,000

### Median sale price

Median price

\$385,000

Property type

House

Suburb

NORTH  
WONTHAGGI

Period

01 October 2018 to 30 September  
2019

Source

pricfinder

### Comparable property sales

These are the three properties sold within five kilometres of the property for sale in the last 18 months that the estate agent or agent's representative considers to be most comparable to the property for sale.

#### Address of comparable property

#### Price

#### Date of sale

1 KIRRAK ST, NORTH WONTHAGGI, VIC 3995	\$417,500	19/03/2019
73 HAGELTHORN ST, WONTHAGGI, VIC 3995	\$370,000	06/04/2019
24 PEAR TREE CL, NORTH WONTHAGGI, VIC 3995	\$389,000	22/05/2019

This Statement of Information was prepared on:

07/10/2019