

Statement of Information

Single residential property located in the Melbourne metropolitan area

Section 47AF of the Estate Agents Act 1980

Property offered for sale

Address
Including suburb and
postcode

303/48 OLEANDER DRIVE MILL PARK VIC 3082

Indicative selling price

For the meaning of this price see consumer.vic.gov.au/underquoting (*Delete single price or range as applicable)

Single Price

\$399,000

or range
between

&

Median sale price

(*Delete house or unit as applicable)

Median Price

\$520,000

Property type

Unit

Suburb

Mill Park

Period-from

01 Oct 2023

to

30 Sep 2024

Source

Corelogic

Comparable property sales (*Delete A or B below as applicable)

A* These are the three properties sold within two kilometres of the property for sale in the last 6 months that the estate agent or agent's representative considers to be most comparable to the property for sale.

Address of comparable property

Price

Date of sale

206/30 BUSH BOULEVARD MILL PARK VIC 3082	\$405,500	05-Jun-24
304/30 BUSH BOULEVARD MILL PARK VIC 3082	\$410,000	12-May-23
101/55 OLEANDER DRIVE MILL PARK VIC 3082	\$412,000	21-Oct-23

OR

B* ~~The estate agent or agent's representative reasonably believes that fewer than three comparable properties were sold within two kilometres of the property for sale in the last 6 months.~~

This Statement of Information was prepared on: 31 October 2024

Dhaval Chitnis
M 0422073491
E dhaval@residerre.com.au



**206/30 BUSH BOULEVARD MILL
PARK VIC 3082**

2 2 1

Sold Price **\$405,500** Sold Date **05-Jun-24**

Distance **0.06km**

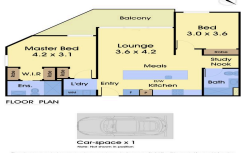

**304/30 BUSH BOULEVARD MILL
PARK VIC 3082**

2 2 1

Sold Price **\$410,000** Sold Date **12-May-23**

Distance **0.06km**



**101/55 OLEANDER DRIVE MILL
PARK VIC 3082**

2 2 1

Sold Price **\$412,000** Sold Date **21-Oct-23**

Distance **0.1km**

RS = Recent sale UN = Undisclosed Sale

DISCLAIMER Whilst all reasonable effort is made to ensure the information in this publication is current, CoreLogic does not warrant the accuracy or completeness of the data and information contained in this publication and to the full extent not prohibited by law excludes all for any loss or damage arising in connection with the data and information contained in this publication.

The State of Victoria owns the copyright in the Property Sales Data and reproduction of that data in any way without the consent of the State of Victoria will constitute a breach of the Copyright Act 1968 (Cth). The State of Victoria does not warrant the accuracy or completeness of the Property Sales Data and any person using or relying upon such information does so on the basis that the State of Victoria accepts no responsibility or liability whatsoever for any errors, faults, defects or omissions in the information supplied.