

## Statement of Information

**Single residential property located in the Melbourne metropolitan area****Section 47AF of the Estate Agents Act 1980****Property offered for sale**

Address  
Including suburb and  
postcode

990 Yan Yean Road, Doreen Vic 3754

**Indicative selling price**For the meaning of this price see [consumer.vic.gov.au/underquoting](http://consumer.vic.gov.au/underquoting)

Range between \$1,100,000

&amp;

\$1,200,000

**Median sale price**

Median price \$600,000

House

X

Unit

Suburb Doreen

Period - From 01/04/2017

to

31/03/2018

Source REIV

**Comparable property sales (\*Delete A or B below as applicable)**

**A\*** ~~These are the three properties sold within two kilometres of the property for sale in the last six months that the estate agent or agent's representative considers to be most comparable to the property for sale.~~

Address of comparable property	Price	Date of sale
1		
2		
3		

OR

**B\*** The estate agent or agent's representative reasonably believes that fewer than three comparable properties were sold within two kilometres of the property for sale in the last six months.

990 Yan Yean Road, Doreen Vic 3754

DARREN JONES

Daniel Leibowitz

03 9432 2544

0428 812 636

daniel@darrenjones.com.au

**Indicative Selling Price**

\$1,100,000 - \$1,200,000

**Median House Price**

Year ending March 2018: \$600,000

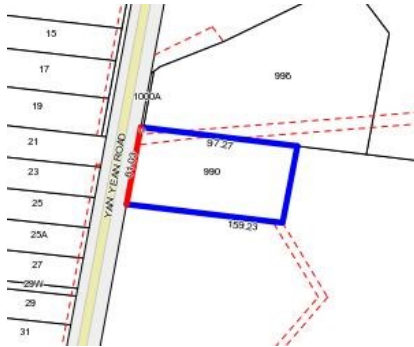

**Rooms:**

**Property Type:** House

**Land Size:** 6000 sqm approx

**Agent Comments**

## Comparable Properties

The estate agent or agent's representative reasonably believes that fewer than three comparable properties were sold within two kilometres of the property for sale in the last six months.