

STATEMENT OF INFORMATION

32 MALLEEFOWL BOULEVARD, BEVERIDGE, VIC 3753

PREPARED BY ARUN NARWAL, LUCKY REAL ESTATE, PHONE: 0452570019

STATEMENT OF INFORMATION

Section 47AF of the Estate Agents Act 1980

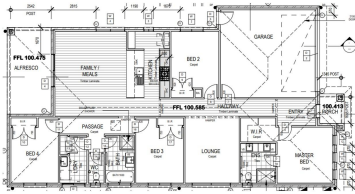

32 MALLEEFOWL BOULEVARD,

 4  2  2

Indicative Selling Price

For the meaning of this price see consumer.vic.au/underquoting

Price Range: \$620,000 to \$660,000

Provided by: Arun Narwal, Lucky Real Estate

MEDIAN SALE PRICE



BEVERIDGE, VIC, 3753

Suburb Median Sale Price (House)

\$675,500

01 October 2023 to 30 September 2024

Provided by: 

COMPARABLE PROPERTIES

These are the three properties sold within five kilometres of the property for sale in the last 18 months that the estate agent or agents representative considers to be most comparable to the property for sale.



272 SPRING ST, BEVERIDGE, VIC 3753

 -  -  -

Sale Price

\$638,000

Sale Date: 12/09/2024

Distance from Property: 1.9km



32 NUMBAT DR, BEVERIDGE, VIC 3753

 4  2  2

Sale Price

\$649,000

Sale Date: 07/06/2024

Distance from Property: 457m



8 WAXFLOWER RD, BEVERIDGE, VIC 3753

 4  2  2

Sale Price

\$660,000

Sale Date: 21/05/2024

Distance from Property: 45m



This report has been compiled on 14/11/2024 by Lucky Real Estate. Property Data Solutions Pty Ltd 2024 - www.pricefinder.com.au

© The State of Victoria owns the copyright in the property sales data and reproduction of that data in any way without the consent of the State of Victoria will constitute a breach of the Copyright Act 1968 (Cth). The State of Victoria does not warrant the accuracy or completeness of the licensed material and any person using or relying upon such information does so on the basis that the State of Victoria accepts no responsibility or liability whatsoever for any errors, faults, defects or omissions in the information supplied.

Statement of Information

Single residential property located outside the Melbourne metropolitan area

Sections 47AF of the Estate Agents Act 1980

Instructions: The instructions in this box do not form part of this Statement of Information and are not required to be included in the completed Statement of Information for the property being offered for sale.

The Director of Consumer Affairs Victoria has approved this form of the Statement of Information for section 47AF of the *Estate Agents Act 1980*.

The estate agent or agent's representative engaged to sell the property is required to prepare this Statement of Information. It must be used when a **single residential property located outside the Melbourne metropolitan area** is being offered for sale. The Determination setting out the local government areas that comprise the Melbourne metropolitan area is published on the Consumer Affairs Victoria website at **consumer.vic.gov.au/underquoting**. The indicative selling price in this Statement of Information may be expressed as a single price, or as a price range with the difference between the upper and lower amounts not more than 10% of the lower amount.

This Statement of Information must be provided to a prospective buyer within two business days of a request and displayed at any open for inspection for the property for sale.

It is recommended that the address of the property being offered for sale be checked at services.land.vic.gov.au/landchannel/content/addressSearch before being entered in this Statement of Information.

Property offered for sale

Address
Including suburb and
postcode

32 MALLEEFOWL BOULEVARD, BEVERIDGE, VIC 3753

Indicative selling price

For the meaning of this price see consumer.vic.gov.au/underquoting

Price Range: \$620,000 to \$660,000

Median sale price

Median price: \$675,500

Property type: House

Suburb: BEVERIDGE

Period: 01 October 2023 to 30 September 2024

Source: 

Comparable property sales

These are the three properties sold within five kilometres of the property for sale in the last 18 months that the estate agent or agents representative considers to be most comparable to the property for sale.

Address of comparable property	Price	Date of sale
272 SPRING ST, BEVERIDGE, VIC 3753	\$638,000	12/09/2024
32 NUMBAT DR, BEVERIDGE, VIC 3753	\$649,000	07/06/2024
8 WAXFLOWER RD, BEVERIDGE, VIC 3753	\$660,000	21/05/2024

This Statement of Information was prepared on: 14/11/2024