

Statement of Information

Single residential property located in the Melbourne metropolitan area

Section 47AF of the Estate Agents Act 1980

Property offered for sale

Address
Including suburb and
postcode

30 Charles Parade, Wesburn Vic 3799

Indicative selling price

For the meaning of this price see consumer.vic.gov.au/underquoting

Range between \$680,000

&

\$740,000

Median sale price

Median price \$497,500

House

X

Unit

Suburb Wesburn

Period - From 01/01/2018

to

31/12/2018

Source REIV

Comparable property sales (*Delete A or B below as applicable)

A* ~~These are the three properties sold within two kilometres of the property for sale in the last six months that the estate agent or agent's representative considers to be most comparable to the property for sale.~~

Address of comparable property	Price	Date of sale
1		
2		
3		

OR

B* The estate agent or agent's representative reasonably believes that fewer than three comparable properties were sold within two kilometres of the property for sale in the last six months.

30 Charles Parade, Wesburn Vic 3799



Team Yarra Valley

03 5967 1800

03 5966 2800

sales@mcmath.com.au

Indicative Selling Price

\$680,000 - \$740,000

Median House Price

Year ending December 2018: \$497,500

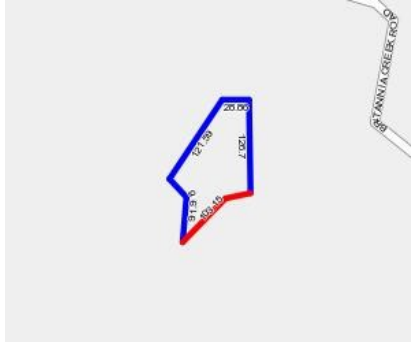

Rooms:

Property Type: House (Previously Occupied - Detached)

Land Size: 9421 sqm approx

Agent Comments

Comparable Properties

The estate agent or agent's representative reasonably believes that fewer than three comparable properties were sold within two kilometres of the property for sale in the last six months.