

Statement of Information

Single residential property located in the Melbourne metropolitan area

Section 47AF of the Estate Agents Act 1980

Property offered for sale

Address
Including suburb and
postcode

220a Nepean Highway, Parkdale Vic 3195

Indicative selling price

For the meaning of this price see consumer.vic.gov.au/underquoting

Range between

\$1,250,000

&

\$1,375,000

Median sale price

Median price

\$1,250,000

Property Type

Townhouse

Suburb

Parkdale

Period - From

19/03/2024

to

18/03/2025

Source

Property Data

Comparable property sales (*Delete A or B below as applicable)

A* These are the three properties sold within two kilometres of the property for sale in the last six months that the estate agent or agent's representative considers to be most comparable to the property for sale.

	Address of comparable property	Price	Date of sale
1	13A Keith St PARKDALE 3195	\$1,440,000	08/03/2025
2	36a Warrigal Rd PARKDALE 3195	\$1,530,000	24/12/2024
3	1/364 Nepean Hwy PARKDALE 3195	\$1,520,000	22/11/2024

OR

~~**B*** The estate agent or agent's representative reasonably believes that fewer than three comparable properties were sold within two kilometres of the property for sale in the last six months.~~

This Statement of Information was prepared on:

19/03/2025 14:03



Jerry Yeghichian
1300117907
0403 042 227
jerry@elevennorth.com.au

Indicative Selling Price
\$1,250,000 - \$1,375,000
Median Townhouse Price
19/03/2024 - 18/03/2025: \$1,250,000

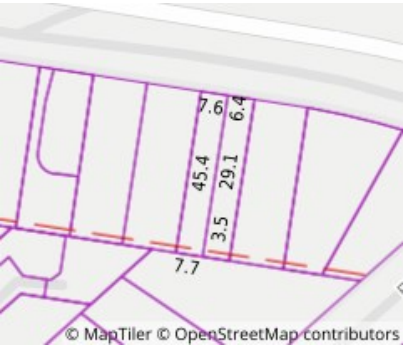

Property Type:
Agent Comments

Comparable Properties



13A Keith St PARKDALE 3195 (REI)

Agent Comments



Price: \$1,440,000
Method: Private Sale
Date: 08/03/2025
Property Type: Townhouse (Single)



36a Warrigal Rd PARKDALE 3195 (REI/VG)

Agent Comments



Price: \$1,530,000
Method: Private Sale
Date: 24/12/2024
Property Type: Townhouse (Single)
Land Size: 258 sqm approx



1/364 Nepean Hwy PARKDALE 3195 (REI/VG)

Agent Comments



Price: \$1,520,000
Method: Private Sale
Date: 22/11/2024
Property Type: Townhouse (Single)
Land Size: 348 sqm approx

Account - 11 North | P: 1300 353 836



The State of Victoria owns the copyright in the property sales data and reproduction of that data in any way without the consent of the State of Victoria will constitute a breach of the Copyright Act 1968 (Cth). The State of Victoria does not warrant the accuracy or completeness of the licensed material and any person using or relying upon such information does so on the basis that the State of Victoria accepts no responsibility or liability whatsoever for any errors, faults, defects or omissions in the information supplied. This information is supplied by Property Data Pty Ltd on behalf of the Real Estate Institute of Victoria.

The information contained herein is to be used as a guide only. Although every care has been taken in the preparation of the information, we stress that particulars herein are for information only and do not constitute representations by the Owners or Agent. Sales data is provided as a guide to market activity, and we do not necessarily claim to have acted as the selling agent in these transactions.