

STATEMENT OF INFORMATION

42 POTTERS HILL ROAD, SAN REMO, VIC 3925

PREPARED BY PBE REAL ESTATE WONTHAGGI



STATEMENT OF INFORMATION

Section 47AF of the Estate Agents Act 1980

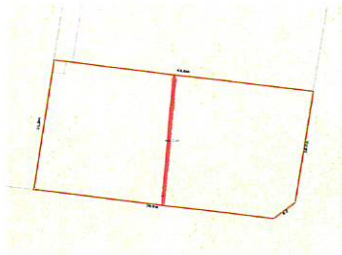

42 POTTERS HILL ROAD, SAN REMO, VIC  -  -  -

Indicative Selling Price

For the meaning of this price see consumer.vic.au/underquoting

Single Price: **\$245,000**

MEDIAN SALE PRICE

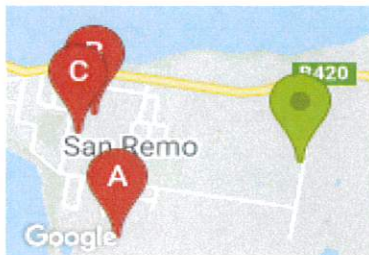

SAN REMO, VIC, 3925

Suburb Median Sale Price (Vacant Land)

\$167,858

01 October 2019 to 30 September 2020

Provided by: 

COMPARABLE PROPERTIES

These are the three properties sold within five kilometres of the property for sale in the last 18 months that the estate agent or agent's representative considers to be most comparable to the property for sale.

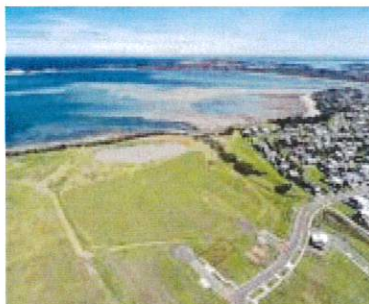

4 EARLSHALL DR, SAN REMO, VIC 3925  -  -  -

Sale Price

\$249,900

Sale Date: 03/11/2019

Distance from Property: 1.3km



10 GARFISH GR, SAN REMO, VIC 3925  -  -  -

Sale Price

\$255,500

Sale Date: 12/11/2019

Distance from Property: 1.4km



6 FLATHEAD CRT, SAN REMO, VIC 3925  -  -  -

Sale Price

\$275,000

Sale Date: 17/01/2020

Distance from Property: 1.5km



This report has been compiled on 19/10/2020 by PBE Real Estate Wonthaggi, Property Data Solutions Pty Ltd 2020 - www.pricefinder.com.au

© The State of Victoria. The State of Victoria owns the copyright in the Property Sales Data and reproduction of the data in any way without the consent of the State of Victoria will constitute a breach of the Copyright Act 1968 (Cth). The State of Victoria does not warrant the accuracy or completeness of the information contained in this report and any person using or relying upon such information does so on the basis that the State of Victoria accepts no responsibility or liability whatsoever for any errors, faults, defects or omissions in the information supplied.