

## Statement of Information

### Single residential property located in the Melbourne metropolitan area

Section 47AF of the Estate Agents Act 1980

#### Property offered for sale

Address  
Including suburb and  
postcode

13a Beresford Road, Lilydale Vic 3140

#### Indicative selling price

For the meaning of this price see [consumer.vic.gov.au/underquoting](http://consumer.vic.gov.au/underquoting)

Range between \$590,000

&

\$640,000

#### Median sale price

Median price \$567,300

House

Unit

X

Suburb

Lilydale

Period - From 01/10/2017

to

31/12/2017

Source REIV

#### Comparable property sales (\*Delete A or B below as applicable)

**A\*** These are the three properties sold within two kilometres of the property for sale in the last six months that the estate agent or agent's representative considers to be most comparable to the property for sale.

	Address of comparable property	Price	Date of sale
1	10 Chirnside Dr CHIRNSIDE PARK 3116	\$612,500	23/11/2017
2	3/13 Gladstone St LILYDALE 3140	\$605,000	06/02/2018
3	3/18-20 Blair St LILYDALE 3140	\$595,000	25/11/2017

OR

**B\*** The estate agent or agent's representative reasonably believes that fewer than three comparable properties were sold within two kilometres of the property for sale in the last six months.

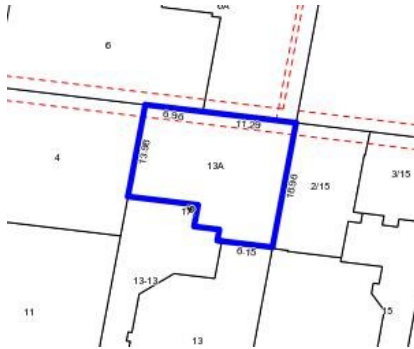

**Rooms:**  
**Property Type:**  
**Agent Comments**

**Indicative Selling Price**  
\$590,000 - \$640,000  
**Median Unit Price**  
December quarter 2017: \$567,300

## Comparable Properties



**10 Chirnside Dr CHIRNSIDE PARK 3116 (REI/VG)**

**Agent Comments**



**Price:** \$612,500  
**Method:** Private Sale  
**Date:** 23/11/2017  
**Rooms:** 4  
**Property Type:** House  
**Land Size:** 355 sqm approx



**3/13 Gladstone St LILYDALE 3140 (REI)**

**Agent Comments**



**Price:** \$605,000  
**Method:** Private Sale  
**Date:** 06/02/2018  
**Rooms:** 6  
**Property Type:** Unit

**3/18-20 Blair St LILYDALE 3140 (REI)**

**Agent Comments**



**Price:** \$595,000  
**Method:** Private Sale  
**Date:** 25/11/2017  
**Rooms:** 5  
**Property Type:** Townhouse (Res)  
**Land Size:** 126 sqm approx