

Basil St

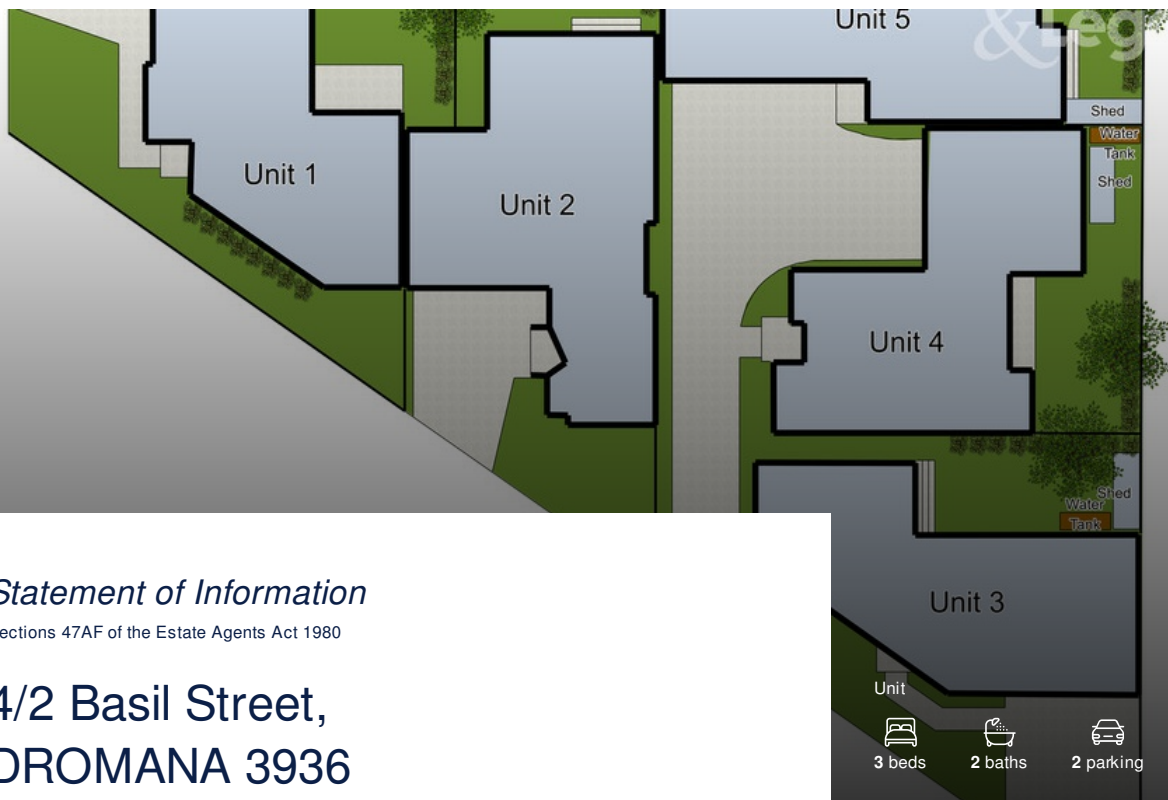

Statement of Information

Sections 47AF of the Estate Agents Act 1980

4/2 Basil Street,
DROMANA 3936

Indicative selling price

For the meaning of this price see consumer.vic.gov.au/underquoting

Range from \$480,000 - \$520,000

Median sale price

Median Unit for Dromana for period Dec 2016 - May 2017
Sourced from **Pricefinder**.

\$466,000

Comparable property sales

These are the three properties sold within two kilometres of the property for sale in the last 6 months that the estate agent or agent's representative considers to be the most comparable to the property for sale.

1/2 Basil St,
Dromana 3936

Price \$520,000 Sold 15 March 2017

2/2 Basil St,
Dromana 3936

Price \$520,000 Sold 15 March 2017

3/2 Basil St,
Dromana 3936

Price \$530,000 Sold 20 April 2017

Indicative selling price, median house price for the suburb and comparable sales information has been provided by the agent in compliance with Estate Agents Act 1980. This information was sourced from Pricefinder.

Contact agents

 **Darrin Marr**
Stockdale & Leggo

03 5987 3233
0409 066 933

darrin.marr@stockdaleleggo.com.au

Stockdale & Leggo (Dromana-Rosebud)

1159-1165 Point Nepean Road,
Rosebud VIC 3939