

# STATEMENT OF INFORMATION

3/34 ANCHORAGE WAY, YARRAWONGA, VIC 3730

PREPARED BY ANDREW SHELL, YARRAWONGA MULWALA REAL ESTATE



## STATEMENT OF INFORMATION

Section 47AF of the Estate Agents Act 1980

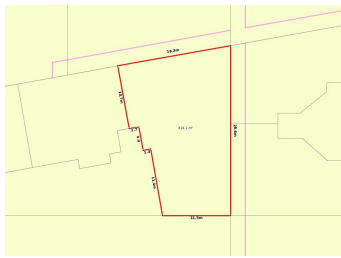

**3/34 ANCHORAGE WAY, YARRAWONGA,**

 **3**

 **-**

 **-**

### Indicative Selling Price

For the meaning of this price see [consumer.vic.au/underquoting](http://consumer.vic.au/underquoting)

Single Price:

**\$695,000**

Provided by: Andrew Shell, Yarrowonga Mulwala Real Estate

## MEDIAN SALE PRICE

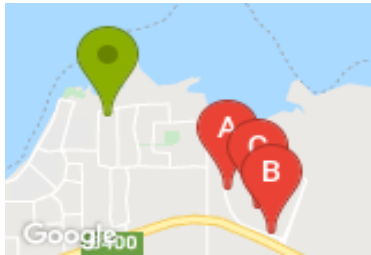

**YARRAWONGA, VIC, 3730**

Suburb Median Sale Price (Unit)

**\$317,500**

01 April 2020 to 31 March 2021

Provided by: 

## COMPARABLE PROPERTIES

These are the three properties sold within five kilometres of the property for sale in the last 18 months that the estate agent or agent's representative considers to be most comparable to the property for sale.



**60 ROBINSON WAY, YARRAWONGA, VIC 3730**

 **3**

 **2**

 **2**

Sale Price

**\*\*\$695,000**

Sale Date: 25/03/2021

Distance from Property: 978m



**8 ROBINSON WAY, YARRAWONGA, VIC 3730**

 **3**

 **2**

 **2**

Sale Price

**\$685,000**

Sale Date: 24/01/2021

Distance from Property: 1.4km



**25 PHILLIP HYLAND DR, YARRAWONGA, VIC**

 **3**

 **2**

 **2**

Sale Price

**\$650,000**

Sale Date: 23/12/2020

Distance from Property: 1.2km



This report has been compiled on 29/04/2021 by Yarrowonga Mulwala Real Estate. Property Data Solutions Pty Ltd 2021 - [www.pricefinder.com.au](http://www.pricefinder.com.au)

© The State of Victoria. The State of Victoria owns the copyright in the Property Sales Data and reproduction of the data in any way without the consent of the State of Victoria will constitute a breach of the Copyright Act 1968 (Cth). The State of Victoria does not warrant the accuracy or completeness of the information contained in this report and any person using or relying upon such information does so on the basis that the State of Victoria accepts no responsibility or liability whatsoever for any errors, faults, defects or omissions in the information supplied.



## Statement of Information

# Single residential property located outside the Melbourne metropolitan area

### Sections 47AF of the Estate Agents Act 1980

**Instructions:** The instructions in this box do not form part of this Statement of Information and are not required to be included in the completed Statement of Information for the property being offered for sale.

The Director of Consumer Affairs Victoria has approved this form of the Statement of Information for section 47AF of the *Estate Agents Act 1980*.

The estate agent or agent's representative engaged to sell the property is required to prepare this Statement of Information. It must be used when **a single residential property located outside the Melbourne metropolitan area** is being offered for sale. The Determination setting out the local government areas that comprise the Melbourne metropolitan area is published on the Consumer Affairs Victoria website at **consumer.vic.gov.au/underquoting**.

The indicative selling price in this Statement of Information may be expressed as a single price, or as a price range with the difference between the upper and lower amounts not more than 10% of the lower amount.

This Statement of Information must be provided to a prospective buyer within two business days of a request and displayed at any open for inspection for the property for sale.

It is recommended that the address of the property being offered for sale be checked at [services.land.vic.gov.au/landchannel/content/addressSearch](https://services.land.vic.gov.au/landchannel/content/addressSearch) before being entered in this Statement of Information.

### Property offered for sale

Address  
Including suburb and  
postcode

3/34 ANCHORAGE WAY, YARRAWONGA, VIC 3730

### Indicative selling price

For the meaning of this price see [consumer.vic.gov.au/underquoting](https://consumer.vic.gov.au/underquoting)

Single Price:

\$695,000

### Median sale price

Median price

\$317,500

Property type

Unit

Suburb

YARRAWONGA

Period

01 April 2020 to 31 March 2021

Source



### Comparable property sales

These are the three properties sold within five kilometres of the property for sale in the last 18 months that the estate agent or agent's representative considers to be most comparable to the property for sale.

#### Address of comparable property

#### Price

#### Date of sale

60 ROBINSON WAY, YARRAWONGA, VIC 3730	**\$695,000	25/03/2021
8 ROBINSON WAY, YARRAWONGA, VIC 3730	\$685,000	24/01/2021
25 PHILLIP HYLAND DR, YARRAWONGA, VIC 3730	\$650,000	23/12/2020

This Statement of Information was prepared on:

29/04/2021