

FOR SALE



Offers Above \$750,000

8 RUFUS STREET, MILPARA



THREE TIMES THE TREAT

- Big brick and Colorbond home, double garage
- Open family/dining, theatre, sheltered patio
- 3187sqm block – privacy and tranquility
- 8m x 15m shed with power, high-clearance door
- Close to supermarket, schools, six minutes to town



4 2 2 3187 m2

Tommie Watts

0476 514 921

0898414022

tommie@merrifield.com.au



Disclaimer: All details on the brochure are presented on the vendor's advice. Prospective purchasers should take necessary actions on their own behalf to satisfy themselves of the details of conditions, contents, fixtures and improvements in regards to this property.
Merrifield Real Estate Pty Ltd JR Stewart Trust T/A Merrifield Real Estate, 258 York Street, Albany WA 6330

8 RUFUS STREET, MILPARA

Specification

Asking Price	Offers Above \$750,000	Land Size	3187.00 m2
Bedrooms	4	Frontage	See Certificate of Title
Bathrooms	2	Restrictive Covenants	See Certificate of Title
Toilets	2	Zoning	Residential R5/20
Parking	2	School Zone	Mount Lockyer PS/ NASHS
Sheds	N/A	Sewer	Not Connected
HWS	Instantaneous Gas	Water	Scheme Connected
Solar	N/A	Internet Connection	NBN Available
Council Rates	\$2,865.75	Building Construction	Brick/ Iron
Water Rates	\$275.72	Insulation	N/A
Strata Levies	N/A	Built/Builder	N/A
Weekly Rent	\$650 - \$700	BAL Assessment	N/A

-- Map Viewer Plus --



Author: Created: 9 July 2024 from Map Viewer Plus: <https://map-viewer-plus.app.landgate.wa.gov.au>

1:1,128
0 0.013 0.027 0.041 0.054 km

© Copyright, Western Australian Land Information Authority. No part of this document or any content appearing on it may be reproduced or published without the prior written permission of Landgate.
Disclaimer: The accuracy and completeness of the information on this document is not guaranteed and is supplied by Landgate 'as is' with no representation or warranty as to its reliability, accuracy, completeness, or fitness for purpose.
Please refer to original documentation for all legal purposes.

WESTERN



AUSTRALIA

TITLE NUMBER

Volume

Folio

2633

887

RECORD OF CERTIFICATE OF TITLE UNDER THE TRANSFER OF LAND ACT 1893

The person described in the first schedule is the registered proprietor of an estate in fee simple in the land described below subject to the reservations, conditions and depth limit contained in the original grant (if a grant issued) and to the limitations, interests, encumbrances and notifications shown in the second schedule.

BGRoberts
REGISTRAR OF TITLES



LAND DESCRIPTION:

LOT 74 ON DEPOSITED PLAN 47534

REGISTERED PROPRIETOR: (FIRST SCHEDULE)

FREDERICK ALBERT BOWNDS
JUNE MAXINE DECRESPIGNY BOWNDS
BOTH OF 8 RUFUS STREET, MILPARA
AS JOINT TENANTS

(T L038095) REGISTERED 11/8/2009

LIMITATIONS, INTERESTS, ENCUMBRANCES AND NOTIFICATIONS: (SECOND SCHEDULE)

Warning: A current search of the sketch of the land should be obtained where detail of position, dimensions or area of the lot is required.
Lot as described in the land description may be a lot or location.

-----END OF CERTIFICATE OF TITLE-----

STATEMENTS:

The statements set out below are not intended to be nor should they be relied on as substitutes for inspection of the land and the relevant documents or for local government, legal, surveying or other professional advice.

SKETCH OF LAND: DP47534
PREVIOUS TITLE: 1558-491
PROPERTY STREET ADDRESS: 8 RUFUS ST, MILPARA.
LOCAL GOVERNMENT AUTHORITY: CITY OF ALBANY





Overview



Scale: 1:1538

Job No.: 37089401

Sequence No.: 241660279

Print Date: 09 Jul 2024



WARNING ASSET PROTECTION APPROVAL MAY BE REQUIRED

Apply for approval to work near our assets at:
[Working near assets \(watercorporation.com.au\)](http://watercorporation.com.au)

Unauthorised work within prescribed proximities of Water Corporation Assets is prohibited.

The Water Corporation has taken due care in the preparation of this map but accepts no responsibility for any inaccuracies or inappropriate use. This plan may be reproduced in its entirety for the purpose of site work planning but shall not otherwise be altered or published in any form without the permission of the Water Corporation. The Water Corporation may need to be advised of any planned ground disturbing activities near facilities on this map. Refer to Brochure - "Protecting Buried Pipelines". Please report any inaccuracies to Asset Registration Team by email to asset.registration@watercorporation.com.au.

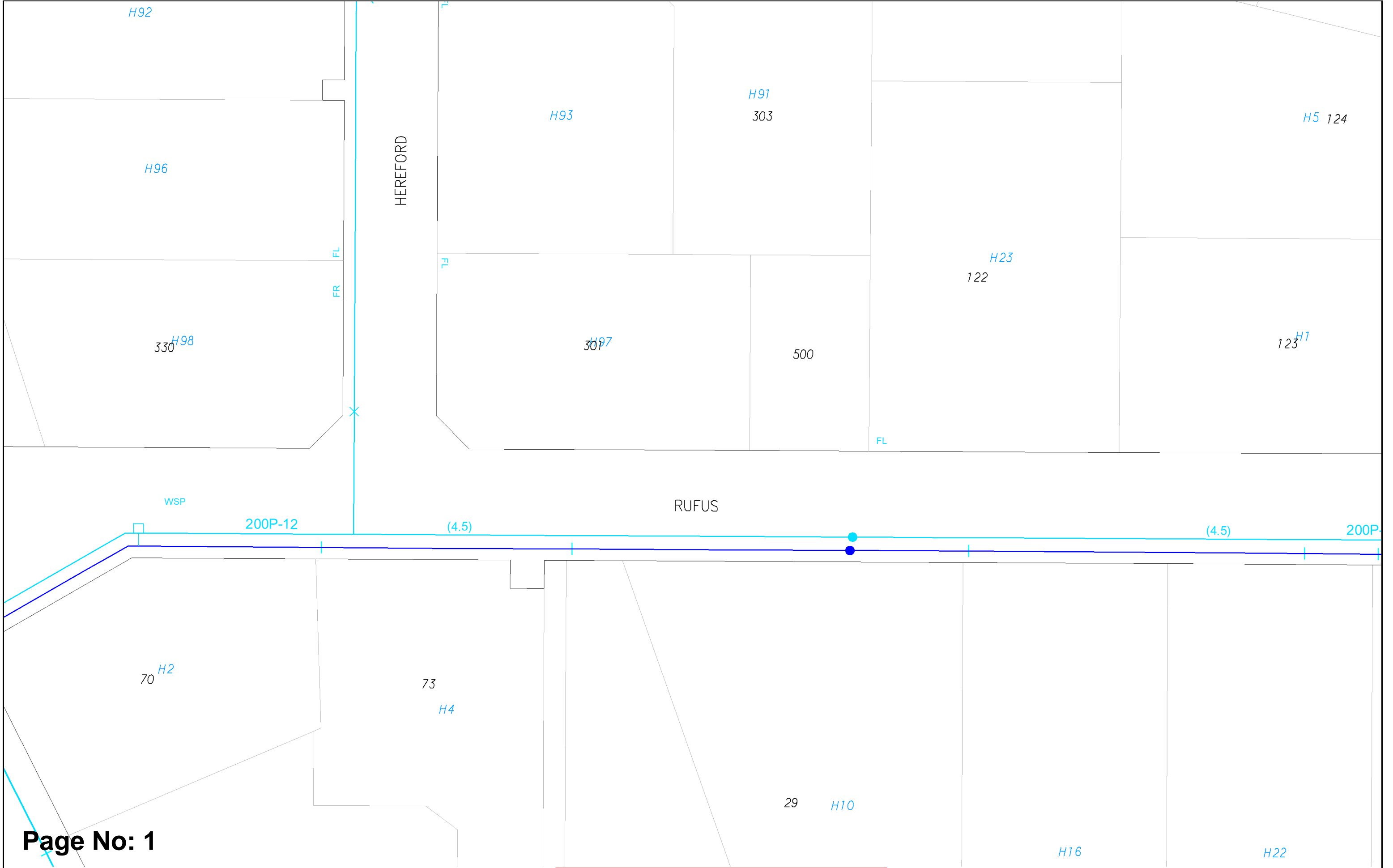

Page No: 1

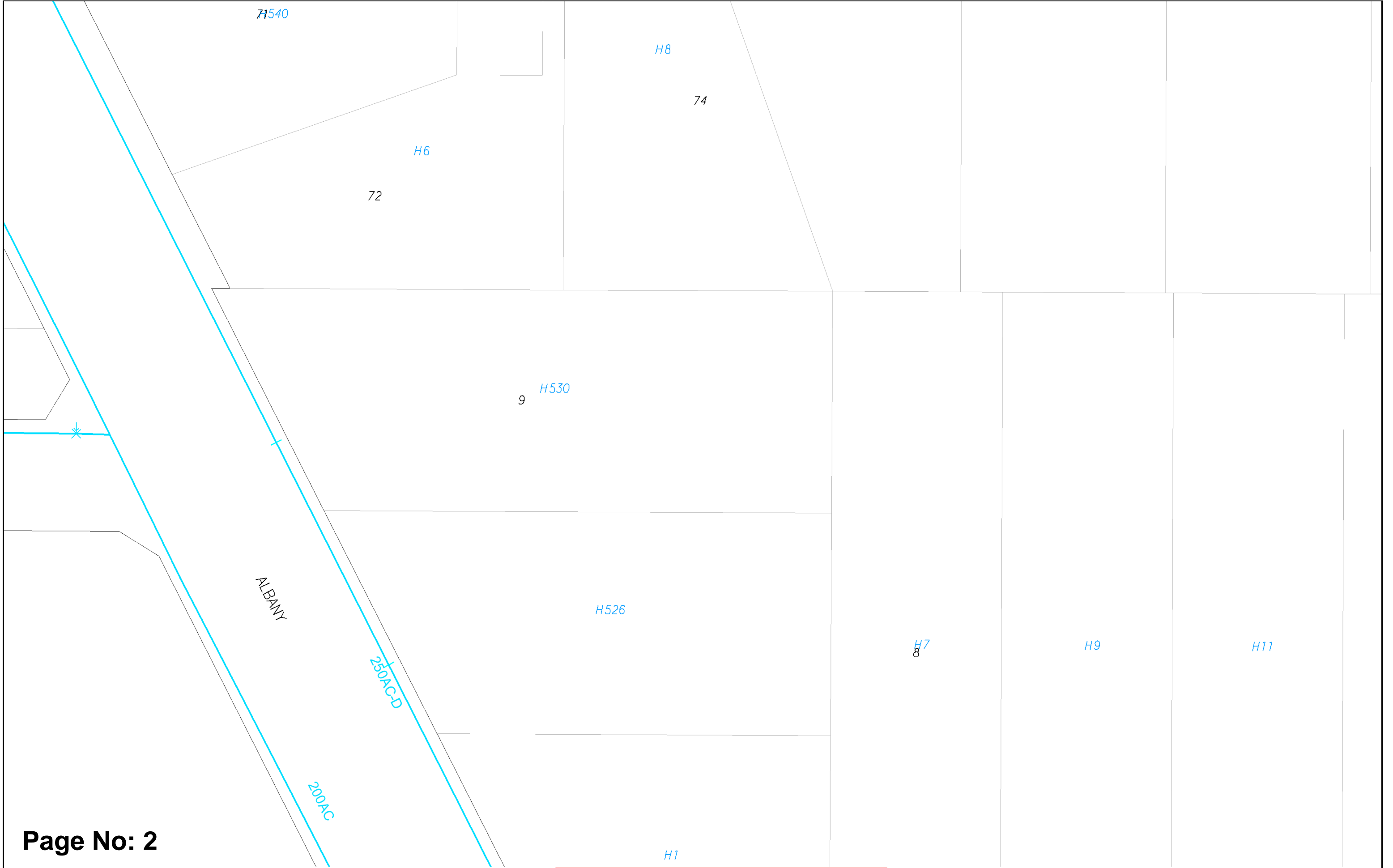

Page No: 2

Plan Legend (summary)











INFORMATION BROCHURE

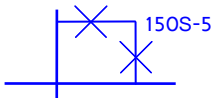
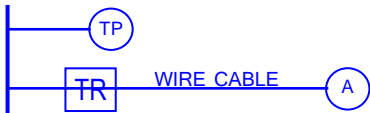

This legend is provided to [Dial Before You Dig](#) users to assist with interpreting Water Corporation plans. A more detailed colour version can be downloaded from www.watercorporation.com.au. (Your business > Working near pipelines > Downloads)

WARNING - Plans may not show all pipes or associated equipment at a site, or their accurate location. **Pothole by hand** to verify asset location before using powered machinery.

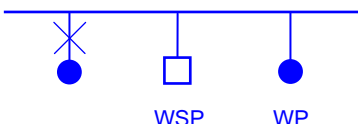
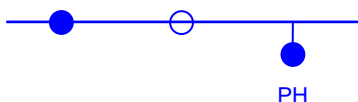
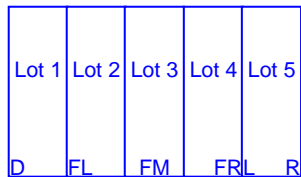
	<p>WATER, SEWERAGE AND DRAINAGE PIPELINES</p> <p>CRITICAL PIPELINE (thick line) EXTRA CAUTION REQUIRED A risk assessment may be required if working near this pipe. Refer to your Dial Before You Dig information or call 131375.</p> <p>Pipes are not always labelled on plans as shown here – assume all pipes are significant and pothole to prove location and depth.</p> <p>P.M. pressure main M.S. main sewer R rising main (i.e. drainage pressure main)</p> <p>Common material abbreviations:</p> <p>AC asbestos cement e.g. 100AC NOTE: AC is brittle and is easily damaged. CI cast iron GRP glass reinforced plastic P PVC - class follows pipe material (e.g.100P-12) RC reinforced concrete S steel VC vitrified clay</p>
	<p>NON-STANDARD ALIGNMENT</p> <p>Pipes are not always located on standard alignments due to local conditions. (i.e. Other than 2.1 m for reticulation mains and 4.5 m for distribution mains.)</p>
	<p>OTHER PIPE SYMBOLS</p> <p>Other numbers or codes shown on pipes are not physical attributes. These are Water Corporation use only.</p>
	<p>CONCRETE ENCASEMENT, SLEEVING AND TUNNELS</p> <p>May be in different forms: steel, poured concrete, box sections, slabs.</p>
	<p>CHANGE INDICATOR ARROW</p> <p>Indicates a change in pipe type or size. e.g. 150mm diameter PVC to 150mm diameter asbestos cement (AC).</p>
	<p>PIPE OVERPASS</p> <p>The overpass symbol indicates the shallower of the two pipes.</p>
	<p>VALVES</p> <p>Many different valve types are in use. Valve may be in a pit or have a visible valve cover. There may be no surface indication.</p> <p>Valves may be shallower than the main or offset from it. e.g. A scour valve (SC) may have a pipe coming away from main pipeline on the opposite side to that indicated on the plan.</p>

 	FIRE SERVICES 100 mm polythene domestic (DOMS) service FS Fire service FHS Fire hydrant service Hydrant may be visible external to the building. Even if not visible a substantial fire service may still be present.	
	PIPE BYPASS Bypass will not be on the same alignment as the main pipeline.	
	CATHODIC PROTECTION (CP) Buried CP equipment may be located some distance from the pipeline being protected interconnected by buried cable. All CP fittings may not be visible. A buried anode – various sizes and configurations TP test point - may be visible on a post or in-ground TR transformer rectifier	
	ACCESS TEE OR MANHOLE OR SERVICE ACCESS PIT NOTE: Opening any manhole or pit is dangerous and is prohibited. Below ground. May not be any visible signs at ground level or may be located in a pit.	
	WASTEWATER ACCESS CHAMBERS (MANHOLES) -- Manhole (shown not labelled) -- Tee or maintenance shaft (shown not labelled) MS maintenance shaft (labelled) WARNING: Opening any manhole or pit is dangerous and is prohibited.	
	WASTEWATER MANHOLE INFORMATION BOXES Square non-trafficable Do not drive vehicles over or place loads. Round trafficable In general if not located in the road treat as if non-trafficable.	
	HAZARDOUS MANHOLE Indicates a potential health hazard from risk of exposure to toxic waste. WARNING: Opening any manhole is dangerous and is prohibited.	
	FLOWMETER Various types of flow meters located in a pit. May be labelled with identifier. (e.g. 50 MFM, 50MM)	
	STANDPIPE, WATER SAMPLING POINT (WSP), WATER SUPPLY POINT (WP) May be located adjacent to mains. Usually there will be some visible indication.	
	Hydrant May not be visible. Hydrant Tee May not be visible. Pillar hydrant Visible	
	PRE-LAID SERVICES D Deferred FL Fully Prelaid Left FM Fully Prelaid Front Middle FR Fully Prelaid Right L Left R Right Code indicates on which side of a lot the water service is located: May be no visible indication at site.	
	SEWER OR DRAINAGE PUMP STATION Several pipes and a pressurised main will be in the vicinity.	
	OPEN CHANNEL OA Landscaped OE Normal Open Earth OF Open channel with flood levee OH Half Pipe OL Lined Channel OS Swale-Shallow Depression OW Natural Water Course Drainage structures, even if dry, must be kept clear of any obstruction such as sand stockpiles.	

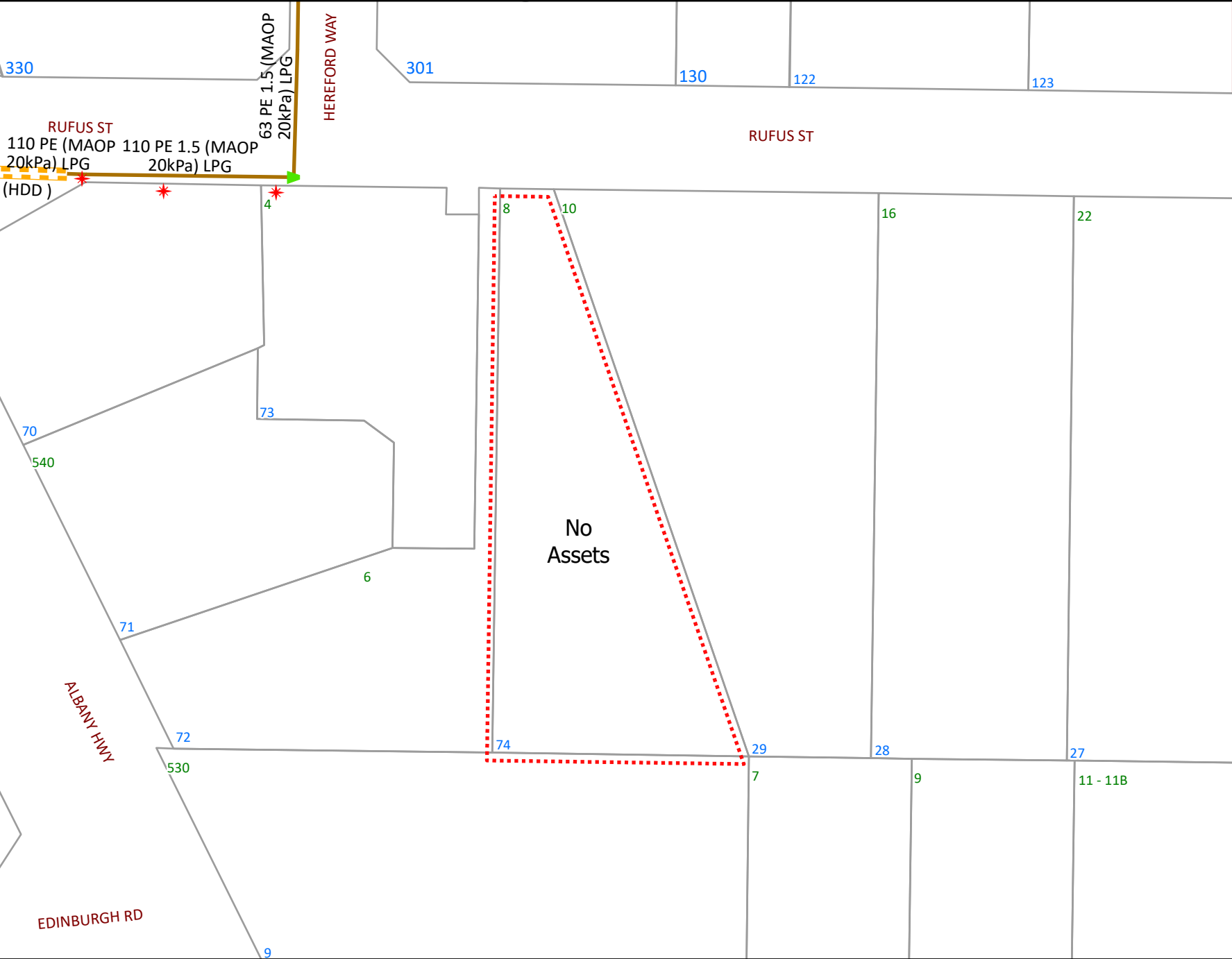

WARNING
Refer to Cover Sheet
for Further Information

 BYDA Enquiry

Please refer to Symbols Sheet
for Further Information

Disclaimer:
Please read all **warnings**, conditions and information on the attached "Underground Asset Details" information sheet. This plan is issued subject to that information and those conditions and **warnings** (including, but not limited to, the "NO HOT WORKS" warning). Plans are current for only **30 days** from date of request, indicative only and not warranted to be accurate. It is your responsibility to carefully locate underground assets and follow safe work practises and procedures (eg pot-holing). ATCO Gas Australia will seek compensation for damage caused to assets.

SYMBOLS SHEET

GAS UTILITY NETWORK

EXISTING GAS NETWORK

- Transmission Pipelines
- Distribution Pipelines
- Distribution Pipe MAOP 350kPa
- Distribution Pipe MAOP 70kPa
- Distribution Pipe MAOP 7kPa
- Not Gassed (none)
- Service Pipe

PROPOSED GAS ASSETS

- Proposed Meter
- Proposed Main
- Common Trenching
- Replacement Program

ABANDONED GAS NETWORK

- Inactive / Removed Meter
- Abandoned Fitting
- Abandoned Valve
- Abandoned Gas Main
- Abandoned Fitting SOLD
- Abandoned Valve SOLD
- Abandoned Gas Main SOLD

COMPOUNDS

- Gate Station
- Pressure Reducing Station
- L.P.G. Tank
- Hydrogen Plant

VALVES

- Isolation Valves
- Service Valves

MONITORING DEVICES

- Flow Monitoring Device
- Pressure Monitoring Device

ASSOCIATED INFRASTRUCTURE

- Associated Asset

DUCTS AND SLEEVES

- Duct
- Horizontal Boring
- Sleeve
- Road Crossing
- Concrete Slabbing

REGULATOR SETS

- Regulator Set
- Boundary Regulator

DELIVERY POINTS

- Meter
- Interval Meter
- Meter Set

PIPE JUNCTIONS

- End Cap
- Expansion Joint
- Reducer
- Tee
- Transition
- Weld
- Monolithic Joint
- Stopple
- Odorizer
- Junctions

PROTECTION DEVICES

- Test Point
- Anode
- Rectifier

FEATURES

- SC Side Elevation
- Obstacle
- See Details
- Not Connected
- Gas Service
- Sign
- Offline Service
- Linked Document
- Pre-Laid Service
- Pre-Laid Service Stairs
- Pre-Laid Service Tee
- Asset end on Main
- Asset ends on Direction Peg
- Reference Line
- Gas Pit
- Arrow Pointer
- Proving Location
- Pressure Upgrade
- Not Gassed
- Suburb
- Local Government

Asset Identification Legend

- Critical Asset (See Cover Sheet WARNINGS)**
- Pipe Diameter (millimetres)
- Pipe Material:
CI = Cast Iron, PE = Polyethylene, GI = Galvanised Iron, PVC = PVC, ST = Steel
- Alignment (in metres from property line)
- Pressure in main & Gas Type
5a) MAOP (Maximum Allowable Operating Pressure)
5b) Gas Type:
NG = Natural Gas.
H2B = Natural Gas Blended with % Hydrogen.
LPG = Liquefied Petroleum Gas.
- Off-line Service service may not be straight line to meter.
(**WARNING OLS may not always be shown on plan**).
See Cover Sheet for More Information.
- Service Valve in the vicinity
(**NOTE: Service Valve may be "BURIED"**)
- Pre-laid Service laid in Common Trench
- Main Status: (See **Cover Sheet WARNINGS**)
9a. AB & ABS = Abandoned Mains, Ab Sold.
9b. PROP = Proposed Mains
- Customer Connection: Does not indicate actual location of Meter Position
D2 (D = Domestic & 2 = Number of Meters)
C1 (C = Commercial & 1 = Number of Meters)
- Additional detail available and Must be obtained if within area of proposed works see Cover Sheet.**
- Depth of Cover (DOC) in metres.

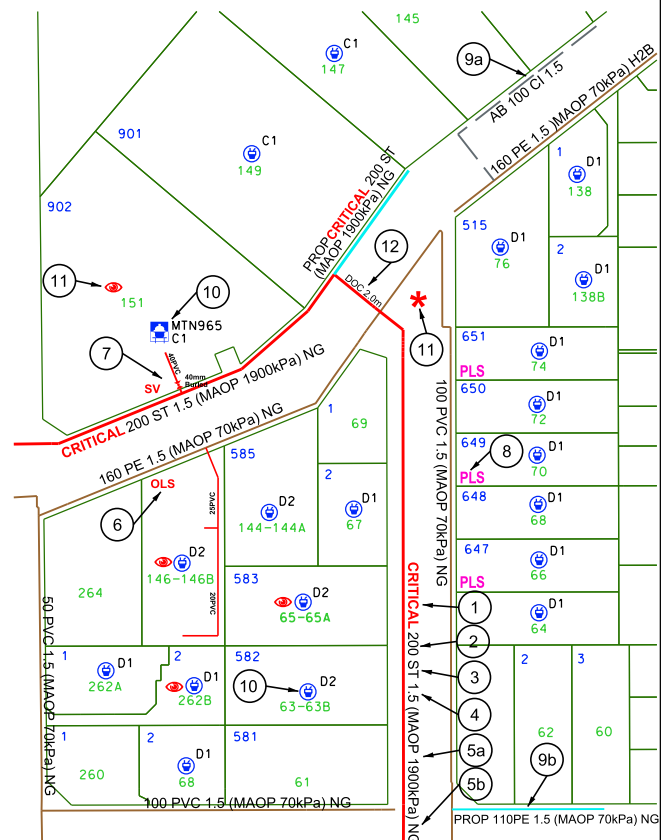

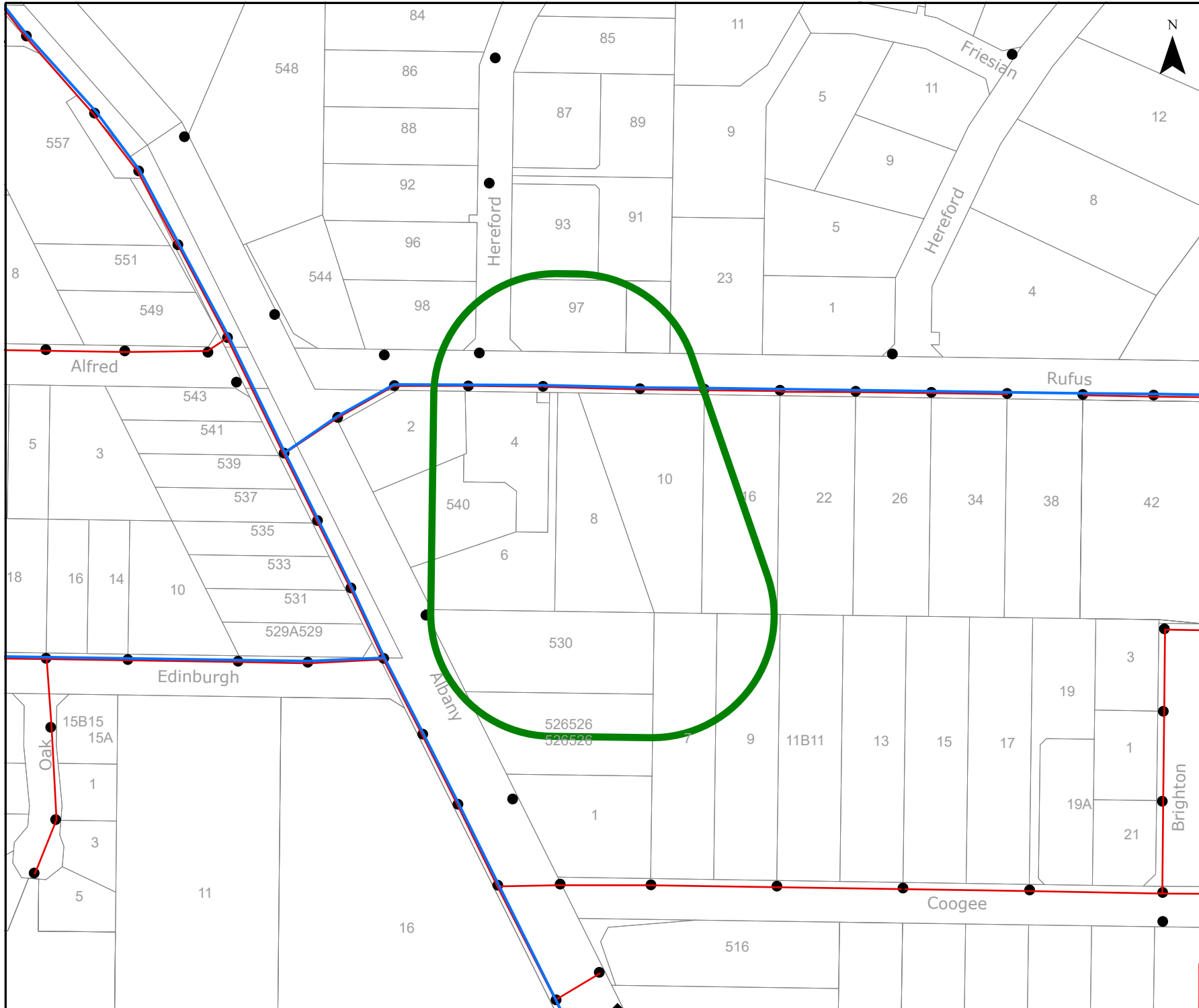

OVERHEAD LEGEND

- Structures**
- Power Pole ■ Transmission Poles
- Transmission Overhead Powerline**
- Transmission (33kV - 330kV)
- Distribution Overhead Powerline**
- High Voltage (1kV - 33kV)
 - Low Voltage (< 1kV)
- Proposed Construction Assets**
- Design Area *
 - High Voltage Overhead Powerline
 - Low Voltage Overhead Powerline
 - Power Pole
- Communications Assets**
- Overhead Pilot Cable
- Feature**
- Area of Interest

* Please refer to coversheet

Privately owned cables NOT SHOWN
(including house services)

This map is INDICATIVE ONLY.
Check that you have enough
clearance from the DANGER ZONES
near overhead powerlines.

Telephone Support: 1300 769 345
Mon to Fri - 08:00 to 16:30

Information valid for 30 days
from date of issue

A4 Scale : 1:2500

WARNING! Look out for
overhead power lines

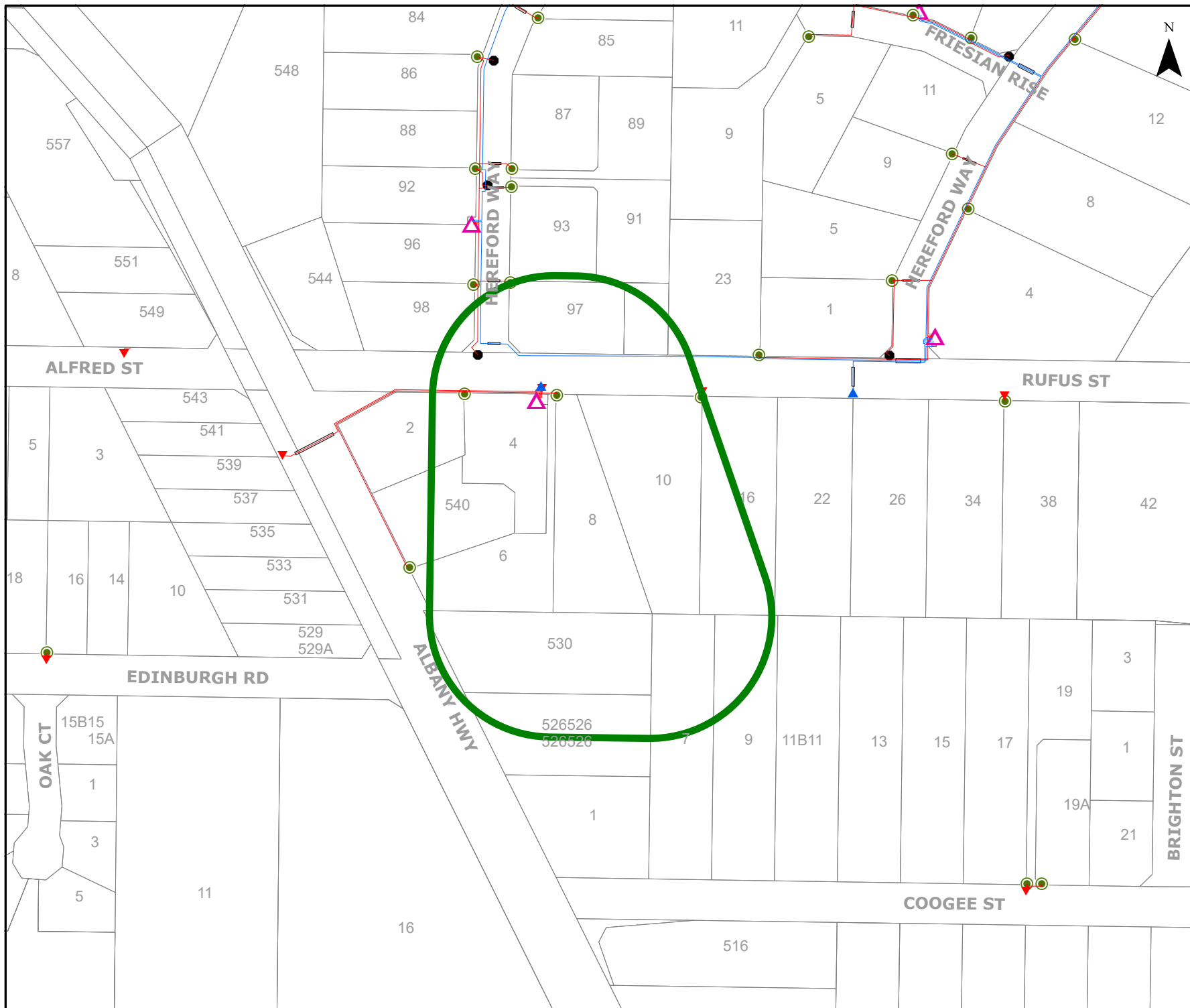

UNDERGROUND LEGEND

Structures	
Pillar	UG Crossing *
Metal Pole	Ring Main Unit
Transformer Site	LV Distribution Frame

Distribution Cables	
High Voltage Cable (1kV - 33kV)	
Low Voltage Cable (< 1kV)	
Street Light Circuit (< 1kV)	
Street Light Pilot (< 1kV)	
Earth Wire	

Cable Pole Terminations	
HV Termination	LV Termination

Proposed Construction Assets	
Design Area *	
High Voltage Underground Cable	
Low Voltage Underground Cable	
Metal Pole	HV Termination
Pillar	LV Termination
Transformer site	

State Underground Power Project	
CURRENT Work Area *	
COMPLETED Area *	

Feature	
Area of Interest	

*** Please refer to coversheet**

Privately owned cables NOT SHOWN (including house services)

This map is INDICATIVE ONLY.
Hand exposure via pothole method is **MANDATORY**.

Telephone Support: 1300 769 345
Mon to Fri - 08:00 to 16:30

Information valid for 30 days from date of issue

A4	Scale : 1:2500
----	----------------

WARNING! Look out for overhead power lines

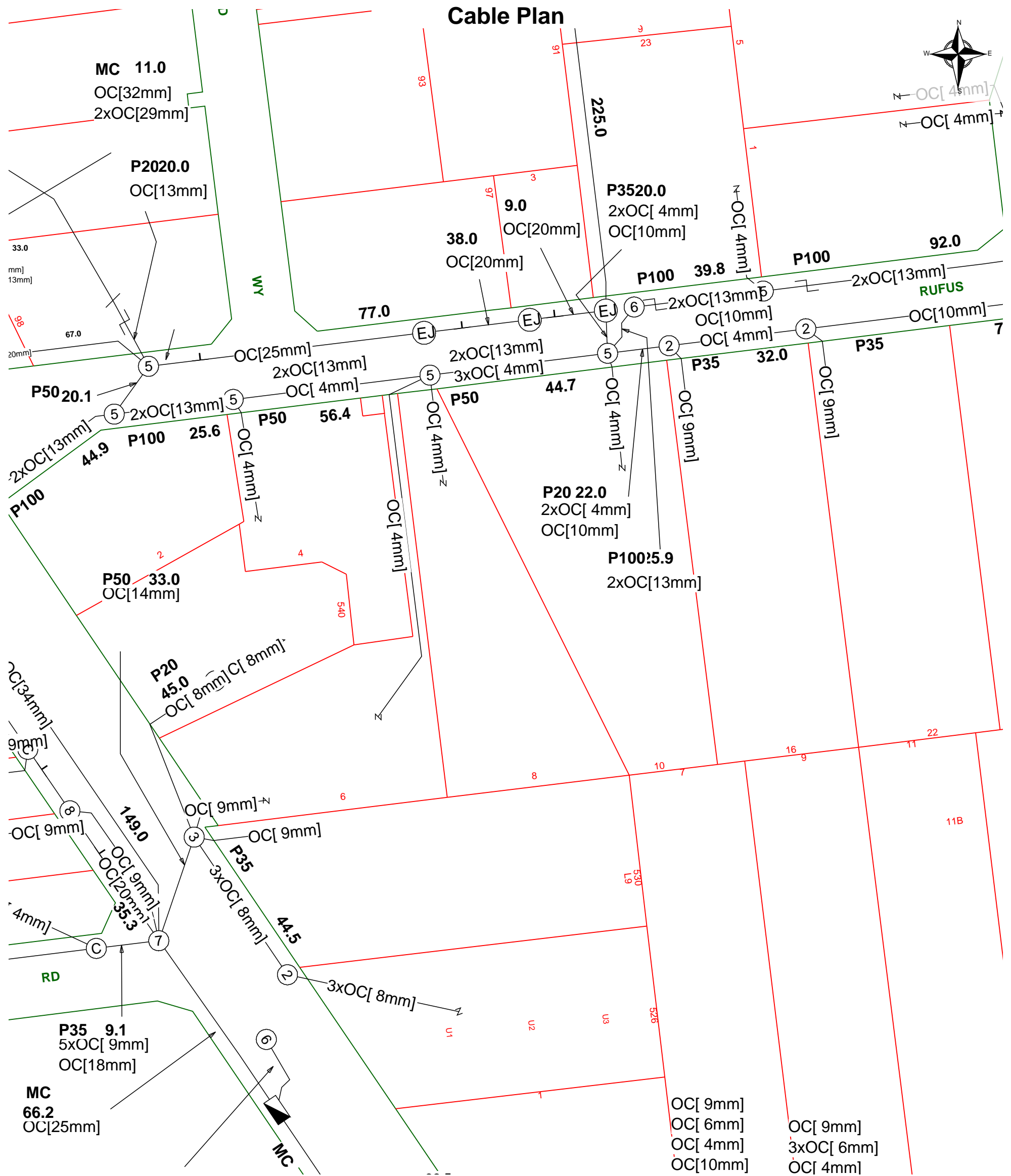

Sequence Number: 241660278

CAUTION: Fibre optic and/ or major network present in plot area. Please read the Duty of Care and contact Telstra Plan Services should you require any assistance.

Generated On 09/07/2024 18:43:51

The above plan must be viewed in conjunction with the Mains Cable Plan on the following page

See the Steps- Telstra Duty of Care that was provided in the email response.

800

Mains Cable Plan



501-600 200 CPFUT (AA)
DEAD
101-300 200 CPFUT (AA)
OC(AA)

WV

RUFUS

EPR ZONE
15.0m RADIUS

AA BA
A100

CA1:B201-300 100/0.64 PIUT (AA)
CA1:B501-600 100/0.64 PIUT (AA)
ABANDONED TRUNK ALNC 777 2/1.27 PEIQC PJ (AA)
CA1:B1-200 200/0.64 PIUT (BA)
3006:DN-AK/1-120 120F/- SMOF FNPEHJ/STD (BA)
1xP28 SUBDUCTS (BA)
F ALNC 1708:AE-HL/1-18 18F/- SMOF FNPEHJ/STD (BA1)
F ALNC 1708:AE-AK/1-6 6F/- SMOF FNPEHJ (BA1)

AA BA
A100

CA1:B201-300 100/0.64 PIUT (AA)
CA1:B501-600 100/0.64 PIUT (AA)
OC[25mm] (AA)
ABANDONED TRUNK ALNC 777 2/1.27 PEIQC PJ (AA)
CA1:B1-200 200/0.64 PIUT (BA)
3006:DN-AK/1-120 120F/- SMOF FNPEHJ/STD (BA)
1xP28 SUBDUCTS (BA)
F ALNC 1708:AE-HL/1-18 18F/- SMOF FNPEHJ/STD (BA1)
F ALNC 1708:AE-AK/1-6 6F/- SMOF FNPEHJ (BA1)

AA 2xOC(AA)



Report Damage: <https://service.telstra.com.au/customer/general/forms/report-damage-to-telstra-equipment>
Ph - 13 22 03
Email - Telstra.Plans@team.telstra.com
Planned Services - ph 1800 653 935 (AEST bus hrs only) General Enquiries

Sequence Number: 241660278

TELSTRA LIMITED A.C.N. 086 174 781

CAUTION: Fibre optic and/ or major network present in plot area. Please read the Duty of Care and contact Telstra Plan Services should you require any assistance.

Generated On 09/07/2024 18:43:53

WARNING

Telstra plans and location information conform to Quality Level "D" of the Australian Standard AS 5488-Classification of Subsurface Utility Information. As such, Telstra supplied location information is indicative only. Spatial accuracy is not applicable to Quality Level D. Refer to AS 5488 for further details. The exact position of Telstra assets can only be validated by physically exposing it. Telstra does not warrant or hold out that its plans are accurate and accepts no responsibility for any inaccuracy. Further on site investigation is required to validate the exact location of Telstra plant prior to commencing construction work. A Certified Locating Organisation is an essential part of the process to validate the exact location of Telstra assets and to ensure the asset is protected during construction works.

See the Steps- Telstra Duty of Care that was provided in the email response.

LEGEND

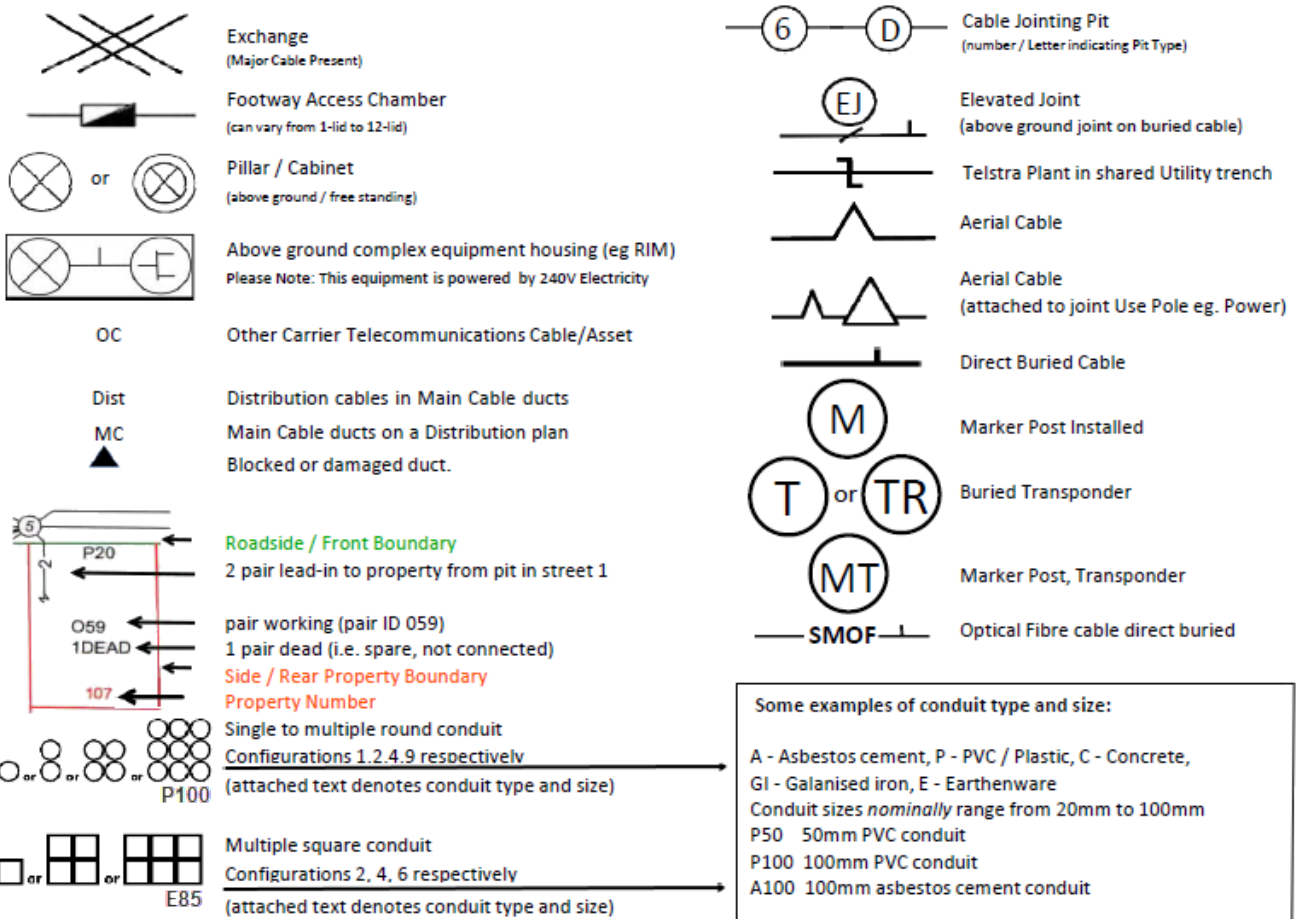

Some Examples of how to read Telstra Plans

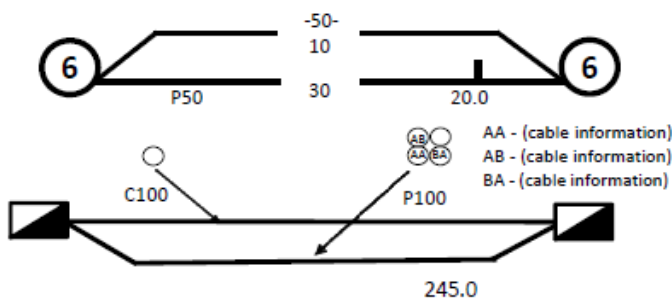

One 50mm PVC conduit (P50) containing a 50-pair and a 10-pair cable between two 6-pits, approximately 20.0m apart, with a direct buried 30-pair cable along the same route

Two separate conduit runs between two footway access chambers (manholes) approximately 245m apart A nest of four 100mm PVC conduits (P100) containing assorted cables in three ducts (one being empty) and one empty 100mm concrete duct (C100) along

Protect our Network:

by maintaining the following distances from our assets:

- 1.0m Mechanical Excavators, Farm Ploughing, Tree Removal
- 500mm Vibrating Plate or Wacker Packer Compactor
- 600mm Heavy Vehicle Traffic (over 3 tonnes) not to be driven across Telstra ducts or plant.
- 1.0m Jackhammers/Pneumatic Breakers
- 2.0m Boring Equipment (in-line, horizontal and vertical)

For more info contact a [Certified Locating Organisation](#) or Telstra Plan Services 1800 653 935



LEGEND



	Parcel and the location
	Pit with size "5"
	Power Pit with size "2E". Valid PIT Size: e.g. 2E, 5E, 6E, 8E, 9E, E, null.
	Manhole
	Pillar
	Cable count of trench is 2. One "Other size" PVC conduit (PO) owned by Telstra (-T-), between pits of sizes, "5" and "9" are 25.0m apart. One 40mm PVC conduit (P40) owned by NBN, between pits of sizes, "5" and "9" are 20.0m apart.
	2 Direct buried cables between pits of sizes, "5" and "9" are 10.0m apart.
	Trench containing any INSERVICE/CONSTRUCTED (Copper/RF/Fibre) cables.
	Trench containing only DESIGNED/PLANNED (Copper/RF/Fibre/Power) cables.
	Trench containing any INSERVICE/CONSTRUCTED (Power) cables.
	Road and the street name "Broadway ST"
Scale	0 20 40 60 Meters 1:2000 1 cm equals 20 m

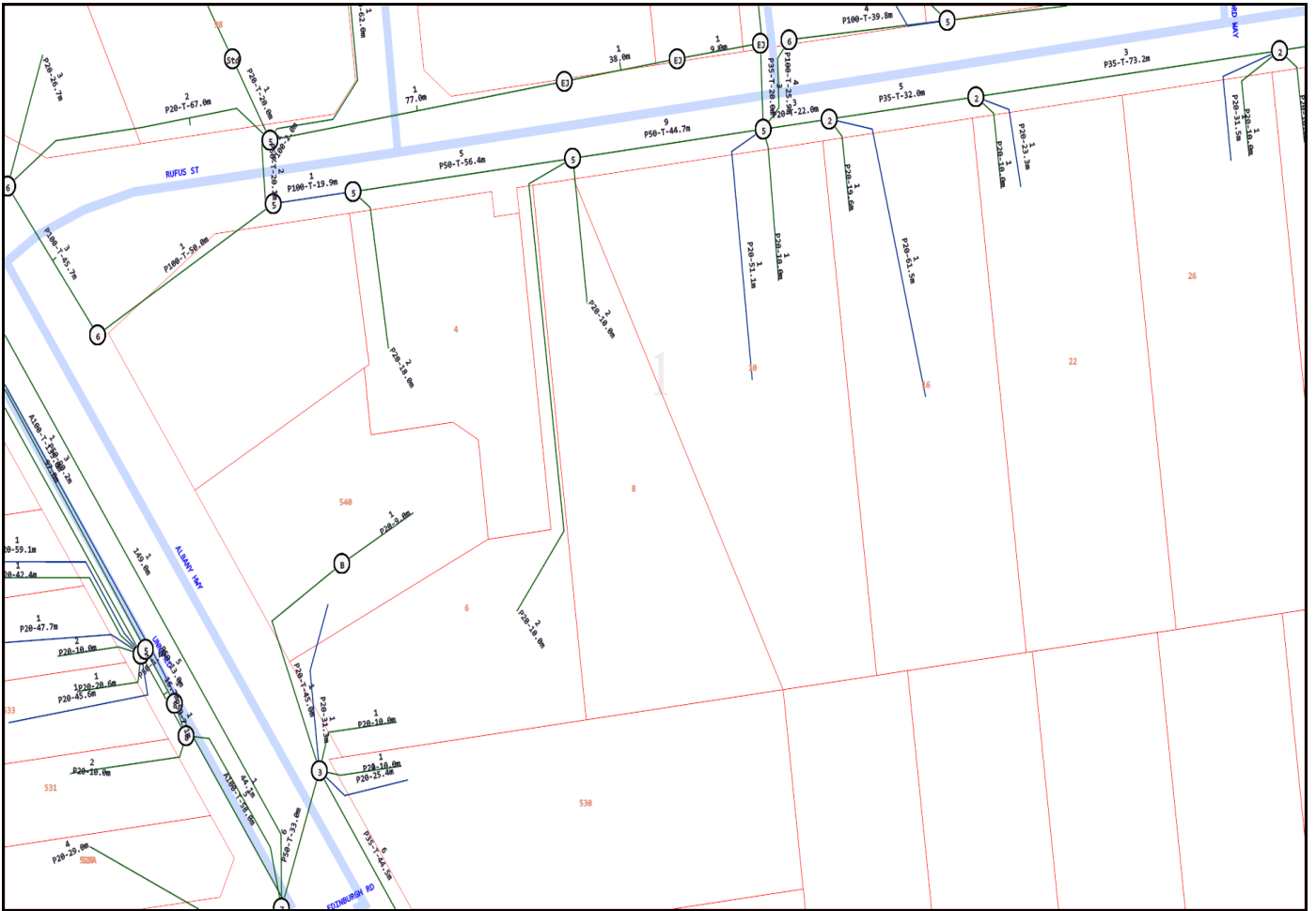

Emergency Contacts

You must immediately report any damage to the **nbn™** network that you are/become aware of. Notification may be by telephone - 1800 626 329.

17/07/2024

The Client
C/- Merrifield Real Estate
258 York Street
ALBANY WA 6330

258 York Street
PO Box 5001
Albany WA 6332
08 9841 4022
admin@merrifield.com.au
www.merrifield.com.au

To whom it may concern,

RE: RENTAL APPRAISAL – 8 RUFUS STREET, MILPARA

We wish to thank you for the opportunity to provide a rental appraisal for the above-mentioned property.

After viewing the property and taking into consideration its location and condition, we feel we can expect to achieve circa **\$650.00 - \$700.00 per week** in the current rental market.

In accordance with requirements to minimum security, internal blind cords and RCD and Smoke Alarm checks, please make your own investigations as to whether this property is compliant. Information can be obtained through the below websites:

Smoke Alarm guidelines:

[DFES_fireinthehome-smokealarm-renting-selling-FAQs.pdf](#)

Internal Blind cord requirements:

[Obligations of landlords - corded internal window coverings | Department of Mines, Industry Regulation and Safety \(commerce.wa.gov.au\)](#)

Minimum Security Requirements:

[Rental property security standards | Department of Mines, Industry Regulation and Safety \(commerce.wa.gov.au\)](https://www.commerce.wa.gov.au/industry-regulation-and-safety/rental-property-security-standards)

Should you have any questions, please feel free to contact me on (08) 9841 4022.

Yours faithfully,

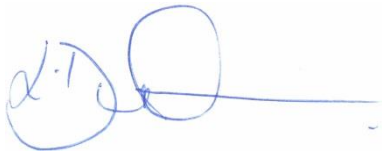
A handwritten signature in blue ink, consisting of a stylized 'L' and 'D' followed by a horizontal line.

Lisa Dunham

Senior Property Manager

Please note, as per our Professional Indemnity Policy, we must state the following: The Statements have been prepared solely for the information of the client and not for any third party. Although every care has been taken in arriving at the figure, we stress that it is an opinion only and not to be taken as a sworn valuation. We must add the warning that we shall not be responsible should the Statements or any part thereof be incorrect or incomplete in any way. This appraisal is deemed valid for 30 days from the date completed, or such earlier date if you become aware of any factors that have any effect on the property value.