

STATEMENT OF INFORMATION

Section 47AF of the Estate Agents Act 1980

**11 MAREE COURT, ROWVILLE, VIC 3178**

4

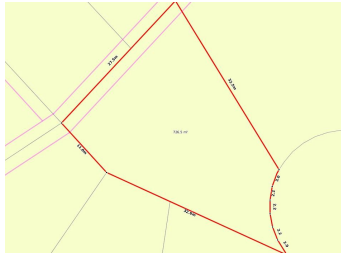

2



2

Indicative Selling PriceFor the meaning of this price see consumer.vic.au/underquoting**Price Range:****\$1,100,000 to \$1,200,000**

Provided by: Tess Maxwell , Ray White Oakleigh

MEDIAN SALE PRICE

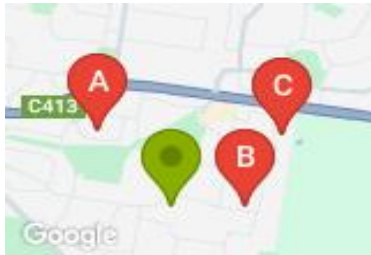
**ROWVILLE, VIC, 3178****Suburb Median Sale Price (House)****\$1,020,000**

01 July 2024 to 30 September 2024

Provided by: pricefinder

COMPARABLE PROPERTIES

These are the three properties sold within two kilometres of the property for sale in the last six months that the estate agent or agents representative considers to be most comparable to the property for sale.

**10 DEVIRA CRT, ROWVILLE, VIC 3178**

4



2



2

Sale Price***\$1,175,000**

Sale Date: 28/11/2024

Distance from Property: 719m

**59 PIA DR, ROWVILLE, VIC 3178**

4



2



2

Sale Price**\$1,183,000**

Sale Date: 01/10/2024

Distance from Property: 481m

**3 HARWOOD CRT, ROWVILLE, VIC 3178**

4



2



2

Sale Price**\$1,150,000**

Sale Date: 03/09/2024

Distance from Property: 884m



This report has been compiled on 13/12/2024 by Ray White Oakleigh. Property Data Solutions Pty Ltd 2024 - www.pricefinder.com.au

© The State of Victoria owns the copyright in the property sales data and reproduction of that data in any way without the consent of the State of Victoria will constitute a breach of the Copyright Act 1968 (Cth). The State of Victoria does not warrant the accuracy or completeness of the licensed material and any person using or relying upon such information does so on the basis that the State of Victoria accepts no responsibility or liability whatsoever for any errors, faults, defects or omissions in the information supplied.

Statement of Information

Single residential property located in the Melbourne metropolitan area

Sections 47AF of the Estate Agents Act 1980

Instructions: The instructions in this box do not form part of this Statement of Information and are not required to be included in the completed Statement of Information for the property being offered for sale.

The Director of Consumer Affairs Victoria has approved this form of the Statement of Information for section 47AF of the *Estate Agents Act 1980*.

The estate agent or agent's representative engaged to sell the property is required to prepare this Statement of Information. It must be used when **a single residential property located in the Melbourne metropolitan area** is being offered for sale. The Determination setting out the local government areas that comprise the Melbourne metropolitan area is published on the Consumer Affairs Victoria website at **consumer.vic.gov.au/underquoting**. The indicative selling price in this Statement of Information may be expressed as a single price, or as a price range with the difference between the upper and lower amounts not more than 10% of the lower amount.

This Statement of Information must be provided to a prospective buyer within two business days of a request and displayed at any open for inspection for the property for sale.

It is recommended that the address of the property being offered for sale be checked at services.land.vic.gov.au/landchannel/content/addressSearch before being entered in this Statement of Information.

Property offered for sale

Address
Including suburb and
postcode

11 MAREE COURT, ROWVILLE, VIC 3178

Indicative selling price

For the meaning of this price see consumer.vic.gov.au/underquoting

Price Range:

\$1,100,000 to \$1,200,000

Median sale price

Median price

\$1,020,000

Property type

House

Suburb

ROWVILLE

Period

01 July 2024 to 30 September 2024

Source



Comparable property sales

These are the three properties sold within two kilometres of the property for sale in the last six months that the estate agent or agents representative considers to be most comparable to the property for sale.

Address of comparable property	Price	Date of sale
10 DEVIRA CRT, ROWVILLE, VIC 3178	*\$1,175,000	28/11/2024
59 PIA DR, ROWVILLE, VIC 3178	\$1,183,000	01/10/2024
3 HARWOOD CRT, ROWVILLE, VIC 3178	\$1,150,000	03/09/2024

This Statement of Information was prepared on:

13/12/2024